

PEEK Screws

Pan Head Phillips.....4-5
 Pan Head Slotted.....6-8
 Flat Head Phillips.....9-10
 Flat Head Slotted.....11-13
 Hex Head.....14-16
 Socket Head cap.....17-18

PEEK Nuts

Machine19

PEEK Washers

Machine.....20

PEEK Screws Metric

Pan Head Phillips.....21-22
 Pan Head Slotted.....23-24
 Flat Head Phillips.....25-26
 Flat Head Slotted.....27-28
 Cheese Head Phillips.....29-30
 Cheese Head Slotted.....31-32
 Hex Head.....33-34
 Socket Head Cap.....35-36

PEEK Washers

Machine.....37

PEEK Bearings

Stainless Inserted.....38
 Flanged Sleeve.....39
 Sleeve.....40

ETFE/PTFE (Teflon) Screws

Pan Head Phillips.....41-42
 Pan Head Slotted.....43-45
 Flat Head Phillips.....46-47
 Flat Head Slotted.....48-50
 Hex Head.....51-53
 Socket Head cap.....54-56

ETFE/PTFE (Teflon) Nuts

Machine57

ETFE/PTFE (Teflon) Washers

Machine.....58

ETFE/PTFE (Teflon) Screws Metric

Pan Head Phillips.....59-60
 Pan Head Slotted.....61-62
 Flat Head Phillips.....63-64
 Flat Head Slotted.....65-66
 Cheese Head Phillips.....67-68
 Cheese Head Slotted.....69-70
 Socket Head Cap.....71-72

ETFE/PTFE (Teflon) Washers Metric

Machine73

Ultem Screws

Pan Head Phillips.....87-88
 Pan Head Slotted.....89-91
 Flat Head Phillips.....92-93
 Flat Head Slotted.....94-96
 Hex Head.....97-99
 Socket Head cap.....100-101

Ultem Nuts

Machine102

Ultem Washers

Machine.....103

Ultem Screws Metric

Pan Head Phillips.....104-106
 Pan Head Slotted.....107-109
 Flat Head Phillips.....110-112
 Flat Head Slotted.....113-115
 Cheese Head Phillips.....116-118
 Cheese Head Slotted.....119-121
 Socket Head Cap.....122-124

Ultem Nuts Metric

Machine125

Ultem Washers

Machine.....126

ETFE/PTFE (Teflon)

Information Page

Technique
Eng.,
Inc.,
13950 Polo Trail Dr.
Lake Forest, IL 60045-5103
877.228.4203
(847.816.1870)
847.816.0130 fax
www.techniqueeng.com

TEI's ETFE/PTFE Fasteners

- *Excellent heat resistance
- *Excellent chemical resistance.
- *Continuous service temperature of 356°F (180°C). Mechanical properties retained to temperatures over 570°F (300°C).
- *Wear resistant.
- *Lubricated.
- *Radiation resistant.
- *UL94-V-0 flammability rating.

Cost Effective

- *Replacement for certain metals.
- *Light weight.
- *Injection molded.

ISO Design and Production Standards

- *TEI. is an ISO 9001:2008 registered company.
- *All dimensions follow the Machinery's Handbook 29th Edition, 2012 printing.



ETFE/PTFE (Teflon) Pan Head Phillips Screws

4-40 Pan Head Phillips	Part No.	Length (a)
Machine Screw, Pan Head Phillips, 4-40 Thread	TF440-14PHP-01	1/4"
	TF440-38PHP-01	3/8"
	TF440-12PHP-01	1/2"
	TF440-58PHP-01	5/8"
	TF440-34PHP-01	3/4"
	TF440-78PHP-01	7/8"
	TF440-11PHP-01	1"

b = 0.05
c = 0.21

6-32 Pan Head Phillips	Part No.	Length (a)
Machine Screw, Pan Head Phillips, 6-32 Thread	TF632-14PHP-01	1/4"
	TF632-38PHP-01	3/8"
	TF632-12PHP-01	1/2"
	TF632-58PHP-01	5/8"
	TF632-34PHP-01	3/4"
	TF632-78PHP-01	7/8"
	TF632-11PHP-01	1"
	TF632-118PHP-01	1 1/8"
	TF632-114PHP-01	1 1/4"

b = 0.08
c = 0.27

8-32 Pan Head Phillips	Part No.	Length (a)
Machine Screw, Pan Head Phillips, 8-32 Thread	TF832-14PHP-01	1/4"
	TF832-38PHP-01	3/8"
	TF832-12PHP-01	1/2"
	TF832-58PHP-01	5/8"
	TF832-34PHP-01	3/4"
	TF832-78PHP-01	7/8"
	TF832-11PHP-01	1"
	TF832-118PHP-01	1 1/8"
	TF832-114PHP-01	1 1/4"
	TF832-138PHP-01	1 3/8"
	TF832-112PHP-01	1 1/2"

b = 0.10
c = 0.32

10-24 Pan Head Phillips	Part No.	Length (a)
Machine Screw, Pan Head Phillips, 8-32 Thread	TF1024-14PHP-01	1/4"
	TF1024-38PHP-01	3/8"
	TF1024-12PHP-01	1/2"
	TF1024-58PHP-01	5/8"
	TF1024-34PHP-01	3/4"
	TF1024-78PHP-01	7/8"
	TF1024-11PHP-01	1"
	TF1024-118PHP-01	1 1/8"
	TF1024-114PHP-01	1 1/4"
	TF1024-138PHP-01	1 3/8"
	TF1024-112PHP-01	1 1/2"
	TF1024-158PHP-01	1 5/8"
	TF1024-134PHP-01	1 3/4"
	TF1024-178PHP-01	1 7/8"
	TF1024-21PHP-01	2"

b = 0.11
c = 0.37

10-32 Pan Head Phillips	Part No.	Length (a)
Machine Screw, Pan Head Phillips, 10-32 Thread	TF1032-14PHP-01	1/4"
	TF1032-38PHP-01	3/8"
	TF1032-12PHP-01	1/2"
	TF1032-58PHP-01	5/8"
	TF1032-34PHP-01	3/4"
	TF1032-78PHP-01	7/8"
	TF1032-11PHP-01	1"
	TF1032-118PHP-01	1 1/8"
	TF1032-114PHP-01	1 1/4"
	TF1032-138PHP-01	1 3/8"
	TF1032-112PHP-01	1 1/2"
	TF1032-158PHP-01	1 5/8"
	TF1032-134PHP-01	1 3/4"
	TF1032-178PHP-01	1 7/8"
TF1032-21PHP-01	2"	

b = 0.11
c = 0.37

1/4-20 Pan Head Phillips	Part No.	Length (a)
Machine Screw, Pan Head Phillips, 1/4-20 Thread	TF1420-14PHP-01	1/4"
	TF1420-38PHP-01	3/8"
	TF1420-12PHP-01	1/2"
	TF1420-58PHP-01	5/8"
	TF1420-34PHP-01	3/4"
	TF1420-78PHP-01	7/8"
	TF1420-11PHP-01	1"
	TF1420-118PHP-01	1 1/8"
	TF1420-114PHP-01	1 1/4"
	TF1420-138PHP-01	1 3/8"
	TF1420-112PHP-01	1 1/2"
	TF1420-158PHP-01	1 5/8"
	TF1420-134PHP-01	1 3/4"
	TF1420-178PHP-01	1 7/8"
	TF1420-21PHP-01	2"
	TF1420-218PHP-01	2 1/8"
	TF1420-214PHP-01	2 1/4"
	TF1420-238PHP-01	2 3/8"
	TF1420-212PHP-01	2 1/2"

b = 0.14
c = 0.49

Part Numbers listed on this page are made from **Dupont 210 (ETFE)**. Available material grades are:
Dupont PFA 230 (PTFE) – TFA (ex. TFA440-78PHP-01)

Part Number ending in **-01** is for natural Teflon.
Standard colors are: **-02** Black, **-03** Blue, **-04** Red, **-05** Green, **-06** Yellow, **-07** White.
Other sizes, types, colors, and color matches available as special orders. Please call for details.

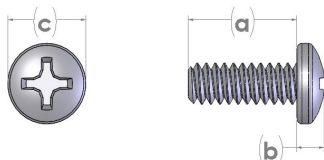



1/4-28 Pan Head Phillips	Part No.	Length (a)
Machine Screw, Pan Head Phillips, 1/4-28 Thread b = 0.14 c = 0.49	TF1428-14PHP-01	1/4"
	TF1428-38PHP-01	3/8"
	TF1428-12PHP-01	1/2"
	TF1428-58PHP-01	5/8"
	TF1428-34PHP-01	3/4"
	TF1428-78PHP-01	7/8"
	TF1428-11PHP-01	1"
	TF1428-118PHP-01	1 1/8"
	TF1428-114PHP-01	1 1/4"
	TF1428-138PHP-01	1 3/8"
	TF1428-112PHP-01	1 1/2"
	TF1428-158PHP-01	1 5/8"
	TF1428-134PHP-01	1 3/4"
	TF1428-178PHP-01	1 7/8"
	TF1428-21PHP-01	2"
	TF1428-218PHP-01	2 1/8"
	TF1428-214PHP-01	2 1/4"
	TF1428-238PHP-01	2 3/8"
	TF1428-212PHP-01	2 1/2"

3/8-16 Pan Head Phillips	Part No.	Length (a)
Machine Screw, Pan Head Phillips, 3/8-16 Thread b = 0.20 c = 0.73	TF3816-14PHP-01	1/4"
	TF3816-38PHP-01	3/8"
	TF3816-12PHP-01	1/2"
	TF3816-58PHP-01	5/8"
	TF3816-34PHP-01	3/4"
	TF3816-78PHP-01	7/8"
	TF3816-11PHP-01	1"
	TF3816-118PHP-01	1 1/8"
	TF3816-114PHP-01	1 1/4"
	TF3816-138PHP-01	1 3/8"
	TF3816-112PHP-01	1 1/2"
	TF3816-158PHP-01	1 5/8"
	TF3816-134PHP-01	1 3/4"
	TF3816-178PHP-01	1 7/8"
	TF3816-21PHP-01	2"
	TF3816-218PHP-01	2 1/8"
	TF3816-214PHP-01	2 1/4"
	TF3816-238PHP-01	2 3/8"
	TF3816-212PHP-01	2 1/2"

5/16-18 Pan Head Phillips	Part No.	Length (a)
Machine Screw, Pan Head Phillips, 5/16-18 Thread b = 0.17 c = 0.60	TF51618-14PHP-01	1/4"
	TF51618-38PHP-01	3/8"
	TF51618-12PHP-01	1/2"
	TF51618-58PHP-01	5/8"
	TF51618-34PHP-01	3/4"
	TF51618-78PHP-01	7/8"
	TF51618-11PHP-01	1"
	TF51618-118PHP-01	1 1/8"
	TF51618-114PHP-01	1 1/4"
	TF51618-138PHP-01	1 3/8"
	TF51618-112PHP-01	1 1/2"
	TF51618-158PHP-01	1 5/8"
	TF51618-134PHP-01	1 3/4"
	TF51618-178PHP-01	1 7/8"
	TF51618-21PHP-01	2"
	TF51618-218PHP-01	2 1/8"
	TF51618-214PHP-01	2 1/4"
	TF51618-238PHP-01	2 3/8"
	TF51618-212PHP-01	2 1/2"

3/8-24 Pan Head Phillips	Part No.	Length (a)
Machine Screw, Pan Head Phillips, 3/8-24 Thread b = 0.20 c = 0.73	TF3824-14PHP-01	1/4"
	TF3824-38PHP-01	3/8"
	TF3824-12PHP-01	1/2"
	TF3824-58PHP-01	5/8"
	TF3824-34PHP-01	3/4"
	TF3824-78PHP-01	7/8"
	TF3824-11PHP-01	1"
	TF3824-118PHP-01	1 1/8"
	TF3824-114PHP-01	1 1/4"
	TF3824-138PHP-01	1 3/8"
	TF3824-112PHP-01	1 1/2"
	TF3824-158PHP-01	1 5/8"
	TF3824-134PHP-01	1 3/4"
	TF3824-178PHP-01	1 7/8"
	TF3824-21PHP-01	2"
	TF3824-218PHP-01	2 1/8"
	TF3824-214PHP-01	2 1/4"
	TF3824-238PHP-01	2 3/8"
	TF3824-212PHP-01	2 1/2"

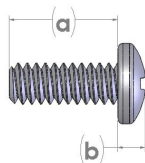

Part Numbers listed on this page are made from **Dupont 210 (ETFE)**.
Available material grades are:
Dupont PFA 230 (PTFE) – TFA (ex. **TFA440-78PHP-01**)

Part Number ending in **-01** is for natural Teflon.
Standard colors are: **-02** Black, **-03** Blue, **-04** Red, **-05** Green, **-06** Yellow,
-07 White.

Other sizes, types, colors, and color matches available as special orders.
Please call for details.

0-80 Pan Head Slotted

Machine Screw, Pan Head Slotted,
0-80 Thread

Part No.	Length (a)
TF080-14PHS-01	1/4"
TF080-38PHS-01	3/8"
TF080-12PHS-01	1/2"

b = 0.03
c = 0.09

2-56 Pan Head Slotted

Machine Screw, Pan Head Slotted,
2-56 Thread

Part No.	Length (a)
TF256-14PHS-01	1/4"
TF256-38PHS-01	3/8"
TF256-12PHS-01	1/2"

b = 0.03
c = 0.16

4-40 Pan Head Slotted

Machine Screw, Pan Head Slotted,
4-40 Thread

Part No.	Length (a)
TF440-14PHS-01	1/4"
TF440-38PHS-01	3/8"
TF440-12PHS-01	1/2"
TF440-58PHS-01	5/8"
TF440-34PHS-01	3/4"
TF440-78PHS-01	7/8"
TF440-11PHS-01	1"

b = 0.08
c = 0.21

6-32 Pan Head Slotted

Machine Screw, Pan Head Slotted,
6-32 Thread

Part No.	Length (a)
TF632-14PHS-01	1/4"
TF632-38PHS-01	3/8"
TF632-12PHS-01	1/2"
TF632-58PHS-01	5/8"
TF632-34PHS-01	3/4"
TF632-78PHS-01	7/8"
TF632-11PHS-01	1"
TF632-118PHS-01	1 1/8"
TF632-114PHS-01	1 1/4"

b = 0.09
c = 0.27

8-32 Pan Head Slotted

Machine Screw, Pan Head Slotted,
8-32 Thread

Part No.	Length (a)
TF832-14PHS-01	1/4"
TF832-38PHS-01	3/8"
TF832-12PHS-01	1/2"
TF832-58PHS-01	5/8"
TF832-34PHS-01	3/4"
TF832-78PHS-01	7/8"
TF832-11PHS-01	1"
TF832-118PHS-01	1 1/8"
TF832-114PHS-01	1 1/4"
TF832-138PHS-01	1 3/8"
TF832-112PHS-01	1 1/2"

b = 0.09
c = 0.32

10-24 Pan Head Slotted

Machine Screw, Pan Head Slotted,
8-32 Thread

Part No.	Length (a)
TF1024-14PHS-01	1/4"
TF1024-38PHS-01	3/8"
TF1024-12PHS-01	1/2"
TF1024-58PHS-01	5/8"
TF1024-34PHS-01	3/4"
TF1024-78PHS-01	7/8"
TF1024-11PHS-01	1"
TF1024-118PHS-01	1 1/8"
TF1024-114PHS-01	1 1/4"
TF1024-138PHS-01	1 3/8"
TF1024-112PHS-01	1 1/2"
TF1024-158PHS-01	1 5/8"
TF1024-134PHS-01	1 3/4"
TF1024-178PH-0S1	1 7/8"
TF1024-21PHS-01	2"

b = 0.10
c = 0.37

10-32 Pan Head Slotted

Machine Screw, Pan Head Slotted,
10-32 Thread

Part No.	Length (a)
TF1032-14PHS-01	1/4"
TF1032-38PHS-01	3/8"
TF1032-12PHS-01	1/2"
TF1032-58PHS-01	5/8"
TF1032-34PHS-01	3/4"
TF1032-78PHS-01	7/8"
TF1032-11PHS-01	1"
TF1032-118PHS-01	1 1/8"
TF1032-114PHS-01	1 1/4"
TF1032-138PHS-01	1 3/8"
TF1032-112PHS-01	1 1/2"
TF1032-158PHS-01	1 5/8"
TF1032-134PHS-01	1 3/4"
TF1032-178PHS-01	1 7/8"
TF1032-21PHS-01	2"

b = 0.10
c = 0.37

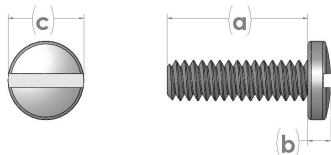

Part Numbers listed on this page are made from **Dupont 210 (ETFE)**.
Available material grades are:

Dupont PFA 230 (PTFE) – TFA (ex. **TFA440-78PHP-01**)

Part Number ending in **-01** is for natural Teflon.

Standard colors are: **-02** Black, **-03** Blue, **-04** Red, **-05** Green, **-06** Yellow,
-07 White.

Other sizes, types, colors, and color matches available as special orders.
Please call for details.

1/4-20 Pan Head Slotted

Machine Screw, Pan Head Slotted,
1/4-20 Thread

b = 0.13
c = 0.37

Part No.	Length (a)
TF1420-14PHS-01	1/4"
TF1420-38PHS-01	3/8"
TF1420-12PHS-01	1/2"
TF1420-58PHS-01	5/8"
TF1420-34PHS-01	3/4"
TF1420-78PHS-01	7/8"
TF1420-11PHS-01	1"
TF1420-118PHS-01	1 1/8"
TF1420-114PHS-01	1 1/4"
TF1420-138PHS-01	1 3/8"
TF1420-112PHS-01	1 1/2"
TF1420-158PHS-01	1 5/8"
TF1420-134PHS-01	1 3/4"
TF1420-178PHS-01	1 7/8"
TF1420-21PHS-01	2"
TF1420-218PHS-01	2 1/8"
TF1420-214PHS-01	2 1/4"
TF1420-238PHS-01	2 3/8"
TF1420-212PHS-01	2 1/2"

1/4-28 Pan Head Slotted

Machine Screw, Pan Head Slotted,
1/4-28 Thread

b = 0.13
c = 0.37

Part No.	Length (a)
TF1428-14PHS-01	1/4"
TF1428-38PHS-01	3/8"
TF1428-12PHS-01	1/2"
TF1428-58PHS-01	5/8"
TF1428-34PHS-01	3/4"
TF1428-78PHS-01	7/8"
TF1428-11PHS-01	1"
TF1428-118PHS-01	1 1/8"
TF1428-114PHS-01	1 1/4"
TF1428-138PHS-01	1 3/8"
TF1428-112PHS-01	1 1/2"
TF1428-158PHS-01	1 5/8"
TF1428-134PHS-01	1 3/4"
TF1428-178PHS-01	1 7/8"
TF1428-21PHS-01	2"
TF1428-218PHS-01	2 1/8"
TF1428-214PHS-01	2 1/4"
TF1428-238PHS-01	2 3/8"
TF1428-212PHS-01	2 1/2"

5/16-18 Pan Head Slotted

Machine Screw, Pan Head Slotted,
5/16-18 Thread

b = 0.17
c = 0.60

Part No.	Length (a)
TF51618-14PHS-01	1/4"
TF51618-38PHS-01	3/8"
TF51618-12PHS-01	1/2"
TF51618-58PHS-01	5/8"
TF51618-34PHS-01	3/4"
TF51618-78PHS-01	7/8"
TF51618-11PHS-01	1"
TF51618-118PHS-01	1 1/8"
TF51618-114PHS-01	1 1/4"
TF51618-138PHS-01	1 3/8"
TF51618-112PHS-01	1 1/2"
TF51618-158PHS-01	1 5/8"
TF51618-134PHS-01	1 3/4"
TF51618-178PHS-01	1 7/8"
TF51618-21PHS-01	2"
TF51618-218PHS-01	2 1/8"
TF51618-214PHS-01	2 1/4"
TF51618-238PHS-01	2 3/8"
TF51618-212PHS-01	2 1/2"

3/8-16 Pan Head Slotted

Machine Screw, Pan Head Slotted,
3/8 16 Thread

b = 0.20
c = 0.73

Part No.	Length (a)
TF3816-14PHS-01	1/4"
TF3816-38PHS-01	3/8"
TF3816-12PHS-01	1/2"
TF3816-58PHS-01	5/8"
TF3816-34PHS-01	3/4"
TF3816-78PHS-01	7/8"
TF3816-11PHS-01	1"
TF3816-118PHS-01	1 1/8"
TF3816-114PHS-01	1 1/4"
TF3816-138PHS-01	1 3/8"
TF3816-112PHS-01	1 1/2"
TF3816-158PHS-01	1 5/8"
TF3816-134PHS-01	1 3/4"
TF3816-178PHS-01	1 7/8"
TF3816-21PHS-01	2"
TF3816-218PHS-01	2 1/8"
TF3816-214PHS-01	2 1/4"
TF3816-238PHS-01	2 3/8"
TF3816-212PHS-01	2 1/2"

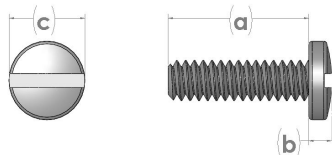

Part Numbers listed on this page are made from **Dupont 210 (ETFE)**.
Available material grades are:
Dupont PFA 230 (PTFE) – TFA (ex. **TFA440-78PHP-01**)

Part Number ending in **-01** is for natural Teflon.
Standard colors are: **-02** Black, **-03** Blue, **-04** Red, **-05** Green, **-06** Yellow,
-07 White.

Other sizes, types, colors, and color matches available as special orders.
Please call for details.

3/8-24 Pan Head Slotted

Machine Screw, Pan Head Slotted,
3/8-24 Thread

b = 0.20
c = 0.73

Part No.	Length (a)
TF3824-14PHS-01	1/4"
TF3824-38PHS-01	3/8"
TF3824-12PHS-01	1/2"
TF3824-58PHS-01	5/8"
TF3824-34PHS-01	3/4"
TF3824-78PHS-01	7/8"
TF3824-11PHS-01	1"
TF3824-118PHS-01	1 1/8"
TF3824-114PHS-01	1 1/4"
TF3824-138PHS-01	1 3/8"
TF3824-112PHS-01	1 1/2"
TF3824-158PHS-01	1 5/8"
TF3824-134PHS-01	1 3/4"
TF3824-178PHS-01	1 7/8"
TF3824-21PHS-01	2"
TF3824-218PHS-01	2 1/8"
TF3824-214PHS-01	2 1/4"
TF3824-238PHS-01	2 3/8"
TF3824-212PHS-01	2 1/2"

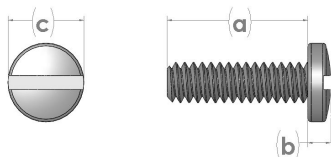

Part Numbers listed on this page are made from **Dupont 210 (ETFE)**.
Available material grades are:

Dupont PFA 230 (PTFE) – TFA (ex. TFA440-78PHP-01)

Part Number ending in **-01** is for natural Teflon.

Standard colors are: **-02** Black, **-03** Blue, **-04** Red, **-05** Green, **-06** Yellow,
-07 White.

Other sizes, types, colors, and color matches available as special orders.
Please call for details.



4-40 Flat Head Phillips	Part No.	Length (a)
Machine Screw, Flat Head Phillips, 4-40 Thread b = 0.05 c = 0.19	TF440-14FHP-01	1/4"
	TF440-38FHP-01	3/8"
	TF440-12FHP-01	1/2"
	TF440-58FHP-01	5/8"
	TF440-34FHP-01	3/4"
	TF440-78FHP-01	7/8"
	TF440-11FHP-01	1"

6-32 Flat Head Phillips	Part No.	Length (a)
Machine Screw, Flat Head Phillips, 6-32 Thread b = 0.08 c = 0.26	TF632-14FHP-01	1/4"
	TF632-38FHP-01	3/8"
	TF632-12FHP-01	1/2"
	TF632-58FHP-01	5/8"
	TF632-34FHP-01	3/4"
	TF632-78FHP-01	7/8"
	TF632-11FHP-01	1"
	TF632-118FHP-01	1 1/8"
	TF632-114FHP-01	1 1/4"

8-32 Flat Head Phillips	Part No.	Length (a)
Machine Screw, Flat Head Phillips, 8-32 Thread b = 0.10 c = 0.31	TF832-14FHP-01	1/4"
	TF832-38FHP-01	3/8"
	TF832-12FHP-01	1/2"
	TF832-58FHP-01	5/8"
	TF832-34FHP-01	3/4"
	TF832-78FHP-01	7/8"
	TF832-11FHP-01	1"
	TF832-118FHP-01	1 1/8"
	TF832-114FHP-01	1 1/4"
	TF832-138FHP-01	1 3/8"

10-24 Flat Head Phillips	Part No.	Length (a)
Machine Screw, Flat Head Phillips, 8-32 Thread b = 0.11 c = 0.36	TF1024-14FHP-01	1/4"
	TF1024-38FHP-01	3/8"
	TF1024-12FHP-01	1/2"
	TF1024-58FHP-01	5/8"
	TF1024-34FHP-01	3/4"
	TF1024-78FHP-01	7/8"
	TF1024-11FHP-01	1"
	TF1024-118FHP-01	1 1/8"
	TF1024-114FHP-01	1 1/4"
	TF1024-138FHP-01	1 3/8"
	TF1024-112FHP-01	1 1/2"
	TF1024-158FHP-01	1 5/8"
	TF1024-134FHP-01	1 3/4"
	TF1024-178FHP-01	1 7/8"
	TF1024-21FHP-01	2"

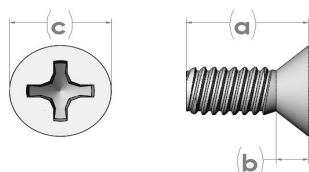

10-32 Flat Head Phillips	Part No.	Length (a)
Machine Screw, Flat Head Phillips, 10-32 Thread b = 0.11 c = 0.36	TF1032-14FHP-01	1/4"
	TF1032-38FHP-01	3/8"
	TF1032-12FHP-01	1/2"
	TF1032-58FHP-01	5/8"
	TF1032-34FHP-01	3/4"
	TF1032-78FHP-01	7/8"
	TF1032-11FHP-01	1"
	TF1032-118FHP-01	1 1/8"
	TF1032-114FHP-01	1 1/4"
	TF1032-138FHP-01	1 3/8"
	TF1032-112FHP-01	1 1/2"
	TF1032-158FHP-01	1 5/8"
	TF1032-134FHP-01	1 3/4"

1/4-20 Flat Head Phillips	Part No.	Length (a)
Machine Screw, Flat Head Phillips, 1/4-20 Thread b = 0.15 c = 0.48	TF1420-14FHP-01	1/4"
	TF1420-38FHP-01	3/8"
	TF1420-12FHP-01	1/2"
	TF1420-58FHP-01	5/8"
	TF1420-34FHP-01	3/4"
	TF1420-78FHP-01	7/8"
	TF1420-11FHP-01	1"
	TF1420-118FHP-01	1 1/8"
	TF1420-114FHP-01	1 1/4"
	TF1420-138FHP-01	1 3/8"
	TF1420-112FHP-01	1 1/2"
	TF1420-158FHP-01	1 5/8"
	TF1420-134FHP-01	1 3/4"
	TF1420-178FHP-01	1 7/8"
	TF1420-21FHP-01	2"
	TF1420-218FHP-01	2 1/8"

Part Numbers listed on this page are made from **Dupont 210 (ETFE)**. Available material grades are:
Dupont PFA 230 (PTFE) – TFA (ex. **TFA440-78PHP-01**)

Part Number ending in **-01** is for natural Teflon.
 Standard colors are: **-02** Black, **-03** Blue, **-04** Red, **-05** Green, **-06** Yellow, **-07** White.
 Other sizes, types, colors, and color matches available as special orders. Please call for details.



ETFE/PTFE (Teflon) Flat Head Phillips Screws

1/4-28 Flat Head Phillips

Machine Screw, Flat Head Phillips,
1/4-28 Thread

b = 0.15
c = 0.48

Part No.	Length (a)
TF1428-14FHP-01	1/4"
TF1428-38FHP-01	3/8"
TF1428-12FHP-01	1/2"
TF1428-58FHP-01	5/8"
TF1428-34FHP-01	3/4"
TF1428-78FHP-01	7/8"
TF1428-11FHP-01	1"
TF1428-118FHP-01	1 1/8"
TF1428-114FHP-01	1 1/4"
TF1428-138FHP-01	1 3/8"
TF1428-112FHP-01	1 1/2"
TF1428-158FHP-01	1 5/8"
TF1428-134FHP-01	1 3/4"
TF1428-178FHP-01	1 7/8"
TF1428-21FHP-01	2"
TF1428-218FHP-01	2 1/8"
TF1428-214FHP-01	2 1/4"
TF1428-238FHP-01	2 3/8"
TF1428-212FHP-01	2 1/2"

3/8-16 Flat Head Phillips

Machine Screw, Flat Head Phillips,
3/8 16 Thread

b = 0.23
c = 0.70

Part No.	Length (a)
TF3816-14FHP-01	1/4"
TF3816-38FHP-01	3/8"
TF3816-12FHP-01	1/2"
TF3816-58FHP-01	5/8"
TF3816-34FHP-01	3/4"
TF3816-78FHP-01	7/8"
TF3816-11FHP-01	1"
TF3816-118FHP-01	1 1/8"
TF3816-114FHP-01	1 1/4"
TF3816-138FHP-01	1 3/8"
TF3816-112FHP-01	1 1/2"
TF3816-158FHP-01	1 5/8"
TF3816-134FHP-01	1 3/4"
TF3816-178FHP-01	1 7/8"
TF3816-21FHP-01	2"
TF3816-218FHP-01	2 1/8"
TF3816-214FHP-01	2 1/4"
TF3816-238FHP-01	2 3/8"
TF3816-212FHP-01	2 1/2"

5/16-18 Flat Head Phillips

Machine Screw, Flat Head Phillips,
5/16-18 Thread

b = 0.19
c = 0.60

Part No.	Length (a)
TF51618-14FHP-01	1/4"
TF51618-38FHP-01	3/8"
TF51618-12FHP-01	1/2"
TF51618-58FHP-01	5/8"
TF51618-34FHP-01	3/4"
TF51618-78FHP-01	7/8"
TF51618-11FHP-01	1"
TF51618-118FHP-01	1 1/8"
TF51618-114FHP-01	1 1/4"
TF51618-138FHP-01	1 3/8"
TF51618-112FHP-01	1 1/2"
TF51618-158FHP-01	1 5/8"
TF51618-134FHP-01	1 3/4"
TF51618-178FHP-01	1 7/8"
TF51618-21FHP-01	2"
TF51618-218FHP-01	2 1/8"
TF51618-214FHP-01	2 1/4"
TF51618-238FHP-01	2 3/8"
TF51618-212FHP-01	2 1/2"

3/8-24 Flat Head Phillips

Machine Screw, Flat Head Phillips,
3/8-24 Thread

b = 0.23
c = 0.70

Part No.	Length (a)
TF3824-14FHP-01	1/4"
TF3824-38FHP-01	3/8"
TF3824-12FHP-01	1/2"
TF3824-58FHP-01	5/8"
TF3824-34FHP-01	3/4"
TF3824-78FHP-01	7/8"
TF3824-11FHP-01	1"
TF3824-118FHP-01	1 1/8"
TF3824-114FHP-01	1 1/4"
TF3824-138FHP-01	1 3/8"
TF3824-112FHP-01	1 1/2"
TF3824-158FHP-01	1 5/8"
TF3824-134FHP-01	1 3/4"
TF3824-178FHP-01	1 7/8"
TF3824-21FHP-01	2"
TF3824-218FHP-01	2 1/8"
TF3824-214FHP-01	2 1/4"
TF3824-238FHP-01	2 3/8"
TF3824-212FHP-01	2 1/2"

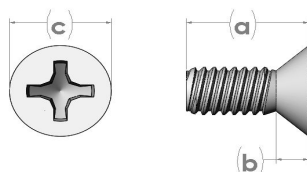

Part Numbers listed on this page are made from **Dupont 210 (ETFE)**.
Available material grades are:
Dupont PFA 230 (PTFE) – TFA (ex. **TFA440-78PHP-01**)

Part Number ending in **-01** is for natural Teflon.
Standard colors are: **-02** Black, **-03** Blue, **-04** Red, **-05** Green, **-06** Yellow,
-07 White.

Other sizes, types, colors, and color matches available as special orders.
Please call for details.



0-80 Flat Head Slotted

Machine Screw, Flat Head Slotted,
0-80 Thread

b = 0.04
c = 0.10

Part No.	Length (a)
TF080-14FHS-01	1/4"
TF080-38FHS-01	3/8"
TF080-12FHS-01	1/2"

2-56 Flat Head Slotted

Machine Screw, Flat Head Slotted,
2-56 Thread

b = 0.05
c = 0.18

Part No.	Length (a)
TF256-14FHS-01	1/4"
TF256-38FHS-01	3/8"
TF256-12FHS-01	1/2"

4-40 Flat Head Slotted

Machine Screw, Flat Head Slotted,
4-40 Thread

b = 0.05
c = 0.19

Part No.	Length (a)
TF440-14FHS-01	1/4"
TF440-38FHS-01	3/8"
TF440-12FHS-01	1/2"
TF440-58FHS-01	5/8"
TF440-34FHS-01	3/4"
TF440-78FHS-01	7/8"
TF440-11FHS-01	1"

6-32 Flat Head Slotted

Machine Screw, Flat Head Slotted,
6-32 Thread

b = 0.08
c = 0.26

Part No.	Length (a)
TF632-14FHS-01	1/4"
TF632-38FHS-01	3/8"
TF632-12FHS-01	1/2"
TF632-58FHS-01	5/8"
TF632-34FHS-01	3/4"
TF632-78FHS-01	7/8"
TF632-11FHS-01	1"
TF632-118FHS-01	1 1/8"
TF632-114FHS-01	1 1/4"

8-32 Flat Head Slotted

Machine Screw, Flat Head Slotted,
8-32 Thread

b = 0.10
c = 0.31

Part No.	Length (a)
TF832-14FHS-01	1/4"
TF832-38FHS-01	3/8"
TF832-12FHS-01	1/2"
TF832-58FHS-01	5/8"
TF832-34FHS-01	3/4"
TF832-78FHS-01	7/8"
TF832-11FHS-01	1"
TF832-118FHS-01	1 1/8"
TF832-114FHS-01	1 1/4"
TF832-138FHS-01	1 3/8"
TF832-112FHS-01	1 1/2"

10-24 Flat Head Slotted

Machine Screw, Flat Head Slotted,
8-32 Thread

b = 0.11
c = 0.36

Part No.	Length (a)
TF1024-14FHS-01	1/4"
TF1024-38FHS-01	3/8"
TF1024-12FHS-01	1/2"
TF1024-58FHS-01	5/8"
TF1024-34FHS-01	3/4"
TF1024-78FHS-01	7/8"
TF1024-11FHS-01	1"
TF1024-118FHS-01	1 1/8"
TF1024-114FHS-01	1 1/4"
TF1024-138FHS-01	1 3/8"
TF1024-112FHS-01	1 1/2"
TF1024-158FHS-01	1 5/8"
TF1024-134FHS-01	1 3/4"
TF1024-178FHS-01	1 7/8"
TF1024-21FHS-01	2"

10-32 Flat Head Slotted

Machine Screw, Flat Head Slotted,
10-32 Thread

b = 0.11
c = 0.36

Part No.	Length (a)
TF1032-14FHS-01	1/4"
TF1032-38FHS-01	3/8"
TF1032-12FHS-01	1/2"
TF1032-58FHS-01	5/8"
TF1032-34FHS-01	3/4"
TF1032-78FHS-01	7/8"
TF1032-11FHS-01	1"
TF1032-118FHS-01	1 1/8"
TF1032-114FHS-01	1 1/4"
TF1032-138FHS-01	1 3/8"
TF1032-112FHS-01	1 1/2"
TF1032-158FHS-01	1 5/8"
TF1032-134FHS-01	1 3/4"
TF1032-178FHS-01	1 7/8"
TF1032-21FHS-01	2"

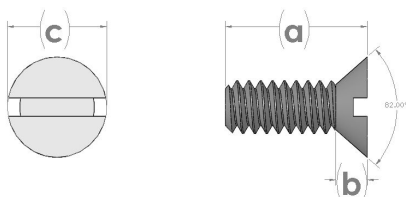

Part Numbers listed on this page are made from **Dupont 210 (ETFE)**.

Available material grades are:

Dupont PFA 230 (PTFE) – TFA (ex. **TFA440-78PHP-01**)

Part Number ending in **-01** is for natural Teflon.

Standard colors are: **-02** Black, **-03** Blue, **-04** Red, **-05** Green, **-06** Yellow, **-07** White.

Other sizes, types, colors, and color matches available as special orders.
Please call for details.



ETFE/PTFE (Teflon) Flat Head Slotted Screws

1/4-20 Flat Head Slotted

Machine Screw, Flat Head Slotted,
1/4-20 Thread

b = 0.15
c = 0.48

Part No.	Length (a)
TF1420-14FHS-01	1/4"
TF1420-38FHS-01	3/8"
TF1420-12FHS-01	1/2"
TF1420-58FHS-01	5/8"
TF1420-34FHS-01	3/4"
TF1420-78FHS-01	7/8"
TF1420-11FHS-01	1"
TF1420-118FHS-01	1 1/8"
TF1420-114FHS-01	1 1/4"
TF1420-138FHS-01	1 3/8"
TF1420-112FHS-01	1 1/2"
TF1420-158FHS-01	1 5/8"
TF1420-134FHS-01	1 3/4"
TF1420-178FHS-01	1 7/8"
TF1420-21FHS-01	2"
TF1420-218FHS-01	2 1/8"
TF1420-214FHS-01	2 1/4"
TF1420-238FHS-01	2 3/8"
TF1420-212FHS-01	2 1/2"

5/16-18 Flat Head Slotted

Machine Screw, Flat Head Slotted,
5/16-18 Thread

b = 0.19
c = 0.60

Part No.	Length (a)
TF51618-14FHS-01	1/4"
TF51618-38FHS-01	3/8"
TF51618-12FHS-01	1/2"
TF51618-58FHS-01	5/8"
TF51618-34FHS-01	3/4"
TF51618-78FHS-01	7/8"
TF51618-11FHS-01	1"
TF51618-118FHS-01	1 1/8"
TF51618-114FHS-01	1 1/4"
TF51618-138FHS-01	1 3/8"
TF51618-112FHS-01	1 1/2"
TF51618-158FHS-01	1 5/8"
TF51618-134FHS-01	1 3/4"
TF51618-178FHS-01	1 7/8"
TF51618-21FHS-01	2"
TF51618-218FHS-01	2 1/8"
TF51618-214FHS-01	2 1/4"
TF51618-238FHS-01	2 3/8"
TF51618-212FHS-01	2 1/2"

1/4-28 Flat Head Slotted

Machine Screw, Flat Head Slotted,
1/4-28 Thread

b = 0.15
c = 0.48

Part No.	Length (a)
TF1428-14FHS-01	1/4"
TF1428-38FHS-01	3/8"
TF1428-12FHS-01	1/2"
TF1428-58FHS-01	5/8"
TF1428-34FHS-01	3/4"
TF1428-78FHS-01	7/8"
TF1428-11FHS-01	1"
TF1428-118FHS-01	1 1/8"
TF1428-114FHS-01	1 1/4"
TF1428-138FHS-01	1 3/8"
TF1428-112FHS-01	1 1/2"
TF1428-158FHS-01	1 5/8"
TF1428-134FHS-01	1 3/4"
TF1428-178FHS-01	1 7/8"
TF1428-21FHS-01	2"
TF1428-218FHS-01	2 1/8"
TF1428-214FHS-01	2 1/4"
TF1428-238FHS-01	2 3/8"
TF1428-212FHS-01	2 1/2"

3/8-16 Flat Head Slotted

Machine Screw, Flat Head Slotted,
3/8 16 Thread

b = 0.23
c = 0.70

Part No.	Length (a)
TF3816-14FHS-01	1/4"
TF3816-38FHS-01	3/8"
TF3816-12FHS-01	1/2"
TF3816-58FHS-01	5/8"
TF3816-34FHS-01	3/4"
TF3816-78FHS-01	7/8"
TF3816-11FHS-01	1"
TF3816-118FHS-01	1 1/8"
TF3816-114FHS-01	1 1/4"
TF3816-138FHS-01	1 3/8"
TF3816-112FHS-01	1 1/2"
TF3816-158FHS-01	1 5/8"
TF3816-134FHS-01	1 3/4"
TF3816-178FHS-01	1 7/8"
TF3816-21FHS-01	2"
TF3816-218FHS-01	2 1/8"
TF3816-214FHS-01	2 1/4"
TF3816-238FHS-01	2 3/8"
TF3816-212FHS-01	2 1/2"

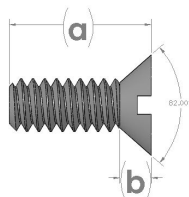
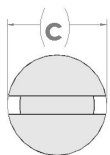

Part Numbers listed on this page are made from **Dupont 210 (ETFE)**.
Available material grades are:
Dupont PFA 230 (PTFE) – TFA (ex. **TFA440-78PHP-01**)

Part Number ending in **-01** is for natural Teflon.
Standard colors are: **-02** Black, **-03** Blue, **-04** Red, **-05** Green, **-06** Yellow,
-07 White.

Other sizes, types, colors, and color matches available as special orders.
Please call for details.



3/8-24 Flat Head Slotted

Part No. Length (a)

Machine Screw, Flat Head Slotted,
3/8-24 Threadb = 0.23
c = 0.70

TF3824-14FHS-01	1/4"
TF3824-38FHS-01	3/8"
TF3824-12FHS-01	1/2"
TF3824-58FHS-01	5/8"
TF3824-34FHS-01	3/4"
TF3824-78FHS-01	7/8"
TF3824-11FHS-01	1"
TF3824-118FHS-01	1 1/8"
TF3824-114FHS-01	1 1/4"
TF3824-138FHS-01	1 3/8"
TF3824-112FHS-01	1 1/2"
TF3824-158FHS-01	1 5/8"
TF3824-134FHS-01	1 3/4"
TF3824-178FHS-01	1 7/8"
TF3824-21FHS-01	2"
TF3824-218FHS-01	2 1/8"
TF3824-214FHS-01	2 1/4"
TF3824-238FHS-01	2 3/8"
TF3824-212FHS-01	2 1/2"

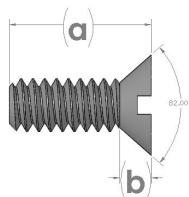
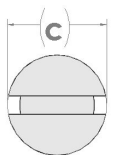
Part Numbers listed on this page are made from **Dupont 210 (ETFE)**.
Available material grades are:**Dupont PFA 230 (PTFE)** – TFA (ex. TFA440-78PHP-01)Part Number ending in **-01** is for natural Teflon.Standard colors are: **-02** Black, **-03** Blue, **-04** Red, **-05** Green, **-06** Yellow,
-07 White.Other sizes, types, colors, and color matches available as special orders.
Please call for details.

0-80 Hex Head	Part No.	Length (a)
Machine Screw, Hex Head, 0-80 Thread	TF080-14SHC-01	1/4"
	TF080-38SHC-01	3/8"
	TF080-12SHC-01	1/2"
b = 0.03 c = 0.12 d = 0.13		

2-56 Hex Head	Part No.	Length (a)
Machine Screw, Hex Head, 2-56 Thread	TF256-14SHC-01	1/4"
	TF256-38SHC-01	3/8"
	TF256-12SHC-01	1/2"
b = 0.04 c = 0.12 d = 0.13		

4-40 Hex Head	Part No.	Length (a)
Machine Screw, Hex Head, 4-40 Thread	TF440-14SHC-01	1/4"
	TF440-38SHC-01	3/8"
	TF440-12SHC-01	1/2"
	TF440-58SHC-01	5/8"
	TF440-34SHC-01	3/4"
	TF440-78SHC-01	7/8"
TF440-11SHC-01	1"	
b = 0.05 c = 0.18 d = 0.20		

6-32 Hex Head	Part No.	Length (a)
Machine Screw, Hex Head, 6-32 Thread	TF632-14SHC-01	1/4"
	TF632-38SHC-01	3/8"
	TF632-12SHC-01	1/2"
	TF632-58SHC-01	5/8"
	TF632-34SHC-01	3/4"
	TF632-78SHC-01	7/8"
	TF632-11SHC-01	1"
	TF632-118SHC-01	1 1/8"
TF632-114SHC-01	1 1/4"	
b = 0.09 c = 0.25 d = 0.27		

8-32 Hex Head	Part No.	Length (a)
Machine Screw, Hex Head, 8-32 Thread	TF832-14SHC-01	1/4"
	TF832-38SHC-01	3/8"
	TF832-12SHC-01	1/2"
	TF832-58SHC-01	5/8"
	TF832-34SHC-01	3/4"
	TF832-78SHC-01	7/8"
	TF832-11SHC-01	1"
	TF832-118SHC-01	1 1/8"
	TF832-114SHC-01	1 1/4"
TF832-138SHC-01	1 3/8"	
TF832-112SHC-01	1 1/2"	
b = 0.10 c = 0.25 d = 0.27		

10-24 Hex Head	Part No.	Length (a)
Machine Screw, Hex Head, 8-32 Thread	TF1024-14SHC-01	1/4"
	TF1024-38SHC-01	3/8"
	TF1024-12SHC-01	1/2"
	TF1024-58SHC-01	5/8"
	TF1024-34SHC-01	3/4"
	TF1024-78SHC-01	7/8"
	TF1024-11SHC-01	1"
	TF1024-118SHC-01	1 1/8"
	TF1024-114SHC-01	1 1/4"
	TF1024-138SHC-01	1 3/8"
	TF1024-112SHC-01	1 1/2"
	TF1024-158SHC-01	1 5/8"
	TF1024-134SHC-01	1 3/4"
	TF1024-178SHC-01	1 7/8"
TF1024-21SHC-01	2"	
b = 0.11 c = 0.31 d = 0.34		

10-32 Hex Head	Part No.	Length (a)
Machine Screw, Hex Head, 10-32 Thread	TF1032-14SHC-01	1/4"
	TF1032-38SHC-01	3/8"
	TF1032-12SHC-01	1/2"
	TF1032-58SHC-01	5/8"
	TF1032-34SHC-01	3/4"
	TF1032-78SHC-01	7/8"
	TF1032-11SHC-01	1"
	TF1032-118SHC-01	1 1/8"
	TF1032-114SHC-01	1 1/4"
	TF1032-138SHC-01	1 3/8"
	TF1032-112SHC-01	1 1/2"
	TF1032-158SHC-01	1 5/8"
	TF1032-134SHC-01	1 3/4"
	TF1032-178SHC-01	1 7/8"
TF1032-21SHC-01	2"	
b = 0.11 c = 0.31 d = 0.34		

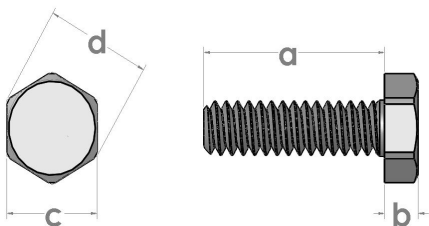

Part Numbers listed on this page are made from **Dupont 210 (ETFE)**.
Available material grades are:
Dupont PFA 230 (PTFE) – TFA (ex. **TFA440-78PHP-01**)

Part Number ending in **-01** is for natural Teflon.
Standard colors are: **-02** Black, **-03** Blue, **-04** Red, **-05** Green, **-06** Yellow,
-07 White.

Other sizes, types, colors, and color matches available as special orders.
Please call for details.

1/4-20 Hex Head	Part No.	Length (a)
Machine Screw, Hex Head, 1/4-20 Thread b = 0.18 c = 0.37 d = 0.40	TF1420-14HH-01	1/4"
	TF1420-38HH-01	3/8"
	TF1420-12HH-01	1/2"
	TF1420-58HH-01	5/8"
	TF1420-34HH-01	3/4"
	TF1420-78HH-01	7/8"
	TF1420-11HH-01	1"
	TF1420-118HH-01	1 1/8"
	TF1420-114HH-01	1 1/4"
	TF1420-138HH-01	1 3/8"
	TF1420-112HH-01	1 1/2"
	TF1420-158HH-01	1 5/8"
	TF1420-134HH-01	1 3/4"
	TF1420-178HH-01	1 7/8"
	TF1420-21HH-01	2"
	TF1420-218HH-01	2 1/8"
	TF1420-214HH-01	2 1/4"
	TF1420-238HH-01	2 3/8"
	TF1420-212HH-01	2 1/2"

5/16-18 Hex Head	Part No.	Length (a)
Machine Screw, Hex Head, 5/16-18 Thread b = 0.18 c = 0.49 d = 0.55	TF51618-14HH-01	1/4"
	TF51618-38HH-01	3/8"
	TF51618-12HH-01	1/2"
	TF51618-58HH-01	5/8"
	TF51618-34HH-01	3/4"
	TF51618-78HH-01	7/8"
	TF51618-11HH-01	1"
	TF51618-118HH-01	1 1/8"
	TF51618-114HH-01	1 1/4"
	TF51618-138HH-01	1 3/8"
	TF51618-112HH-01	1 1/2"
	TF51618-158HH-01	1 5/8"
	TF51618-134HH-01	1 3/4"
	TF51618-178HH-01	1 7/8"
	TF51618-21HH-01	2"
	TF51618-218HH-01	2 1/8"
	TF51618-214HH-01	2 1/4"
	TF51618-238HH-01	2 3/8"
	TF51618-212HH-01	2 1/2"

1/4-28 Hex Head	Part No.	Length (a)
Machine Screw, Hex head, 1/4-28 Thread b = 0.18 c = 0.37 d = 0.40	TF1428-14HH-01	1/4"
	TF1428-38HH-01	3/8"
	TF1428-12HH-01	1/2"
	TF1428-58HH-01	5/8"
	TF1428-34HH-01	3/4"
	TF1428-78HH-01	7/8"
	TF1428-11HH-01	1"
	TF1428-118HH-01	1 1/8"
	TF1428-114HH-01	1 1/4"
	TF1428-138HH-01	1 3/8"
	TF1428-112HH-01	1 1/2"
	TF1428-158HH-01	1 5/8"
	TF1428-134HH-01	1 3/4"
	TF1428-178HH-01	1 7/8"
	TF1428-21HH-01	2"
	TF1428-218HH-01	2 1/8"
	TF1428-214HH-01	2 1/4"
	TF1428-238HH-01	2 3/8"
	TF1428-212HH-01	2 1/2"

3/8-16 Hex Head	Part No.	Length (a)
Machine Screw, Hex Head, 3/8 16 Thread b = 0.28 c = 0.56 d = 0.61	TF3816-14HH-01	1/4"
	TF3816-38HH-01	3/8"
	TF3816-12HH-01	1/2"
	TF3816-58HH-01	5/8"
	TF3816-34HH-01	3/4"
	TF3816-78HH-01	7/8"
	TF3816-11HH-01	1"
	TF3816-118HH-01	1 1/8"
	TF3816-114HH-01	1 1/4"
	TF3816-138HH-01	1 3/8"
	TF3816-112HH-01	1 1/2"
	TF3816-158HH-01	1 5/8"
	TF3816-134HH-01	1 3/4"
	TF3816-178HH-01	1 7/8"
	TF3816-21HH-01	2"
	TF3816-218HH-01	2 1/8"
	TF3816-214HH-01	2 1/4"
	TF3816-238HH-01	2 3/8"
	TF3816-212HH-01	2 1/2"

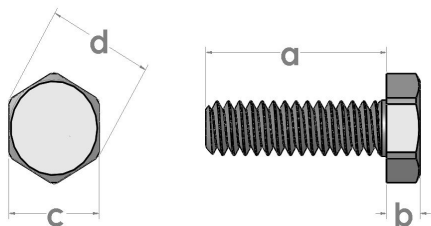

Part Numbers listed on this page are made from **Dupont 210 (ETFE)**.
Available material grades are:
Dupont PFA 230 (PTFE) – TFA (ex. **TFA440-78PHP-01**)

Part Number ending in **-01** is for natural Teflon.
Standard colors are: **-02** Black, **-03** Blue, **-04** Red, **-05** Green, **-06** Yellow,
-07 White.

Other sizes, types, colors, and color matches available as special orders.
Please call for details.

3/8-24 Hex Head

Part No. Length (a)

Machine Screw, Hex Head,
3/8-24 Threadb = 0.28
c = 0.56
d = 0.61

TF3824-14HH-01	1/4"
TF3824-38HH-01	3/8"
TF3824-12HH-01	1/2"
TF3824-58HH-01	5/8"
TF3824-34HH-01	3/4"
TF3824-78HH-01	7/8"
TF3824-11HH-01	1"
TF3824-118HH-01	1 1/8"
TF3824-114HH-01	1 1/4"
TF3824-138HH-01	1 3/8"
TF3824-112HH-01	1 1/2"
TF3824-158HH-01	1 5/8"
TF3824-134HH-01	1 3/4"
TF3824-178HH-01	1 7/8"
TF3824-21HH-01	2"
TF3824-218HH-01	2 1/8"
TF3824-214HH-01	2 1/4"
TF3824-238HH-01	2 3/8"
TF3824-212HH-01	2 1/2"

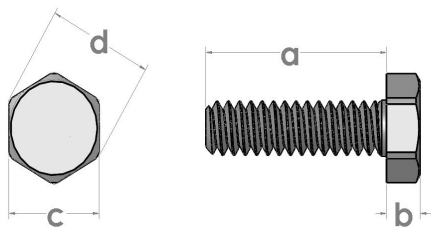
Part Numbers listed on this page are made from **Dupont 210 (ETFE)**.

Available material grades are:

Dupont PFA 230 (PTFE) – TFA (ex. **TFA440-78PHP-01**)Part Number ending in **-01** is for natural Teflon.Standard colors are: **-02** Black, **-03** Blue, **-04** Red, **-05** Green, **-06** Yellow,
-07 White.Other sizes, types, colors, and color matches available as special orders.
Please call for details.

4-40 Socket Head

Machine Screw, Socket Head Cap,
4-40 Thread

b = 0.11
c = 0.18
d = 0.09
e = 0.08

Part No.	Length (a)
TF440-14SHC-01	1/4"
TF440-38SHC-01	3/8"
TF440-12SHC-01	1/2"
TF440-58SHC-01	5/8"
TF440-34SHC-01	3/4"
TF440-78SHC-01	7/8"
TF440-34SHC-01	1"

6-32 Socket Head

Machine Screw, Socket Head,
6-32 Thread

b = 0.14
c = 0.23
d = 0.11
e = 0.10

Part No.	Length (a)
TF632-14SHC-01	1/4"
TF632-38SHC-01	3/8"
TF632-12SHC-01	1/2"
TF632-58SHC-01	5/8"
TF632-34SHC-01	3/4"
TF632-78SHC-01	7/8"
TF632-11SHC-01	1"
TF632-118SHC-01	1 1/8"
TF632-114SHC-01	1 1/4"

8-32 Socket Head

Machine Screw, Socket Head,
8-32 Thread

b = 0.16
c = 0.27
d = 0.14
e = 0.12

Part No.	Length (a)
TF832-14SHC-01	1/4"
TF832-38SHC-01	3/8"
TF832-12SHC-01	1/2"
TF832-58SHC-01	5/8"
TF832-34SHC-01	3/4"
TF832-78SHC-01	7/8"
TF832-11SHC-01	1"
TF832-118SHC-01	1 1/8"
TF832-114SHC-01	1 1/4"
TF832-138SHC-01	1 3/8"
TF832-112SHC-01	1 1/2"

10-24 Socket Head

Machine Screw, Socket Head,
10-24 Thread

b = 0.19
c = 0.31
d = 0.16
e = 0.14

Part No.	Length (a)
TF1024-14SHC-01	1/4"
TF1024-38SHC-01	3/8"
TF1024-12SHC-01	1/2"
TF1024-58SHC-01	5/8"
TF1024-34SHC-01	3/4"
TF1024-78SHC-01	7/8"
TF1024-11SHC-01	1"
TF1024-118SHC-01	1 1/8"
TF1024-114SHC-01	1 1/4"
TF1024-138SHC-01	1 3/8"
TF1024-112SHC-01	1 1/2"
TF1024-158SHC-01	1 5/8"
TF1024-134SHC-01	1 3/4"
TF1024-178SHC-01	1 7/8"
TF1024-21SHC-01	2"

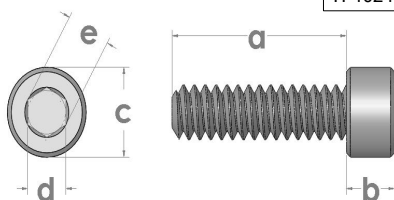

10-32 Socket Head

Machine Screw, Socket Head,
10-32 Thread

b = 0.19
c = 0.31
d = 0.16
e = 0.14

Part No.	Length (a)
TF1032-14SHC-01	1/4"
TF1032-38SHC-01	3/8"
TF1032-12SHC-01	1/2"
TF1032-58SHC-01	5/8"
TF1032-34SHC-01	3/4"
TF1032-78SHC-01	7/8"
TF1032-11SHC-01	1"
TF1032-118SHC-01	1 1/8"
TF1032-114SHC-01	1 1/4"
TF1032-138SHC-01	1 3/8"
TF1032-112SHC-01	1 1/2"
TF1032-158SHC-01	1 5/8"
TF1032-134SHC-01	1 3/4"
TF1032-178SHC-01	1 7/8"
TF1032-21SHC-01	2"

1/4-20 Socket Head

Machine Screw, Socket Head,
1/4-20 Thread

b = 0.25
c = 0.37
d = 0.19
e = 0.16

Part No.	Length (a)
TF1420-14SHC-01	1/4"
TF1420-38SHC-01	3/8"
TF1420-12SHC-01	1/2"
TF1420-58SHC-01	5/8"
TF1420-34SHC-01	3/4"
TF1420-78SHC-01	7/8"
TF1420-11SHC-01	1"
TF1420-118SHC-01	1 1/8"
TF1420-114SHC-01	1 1/4"
TF1420-138SHC-01	1 3/8"
TF1420-112SHC-01	1 1/2"
TF1420-158SHC-01	1 5/8"
TF1420-134SHC-01	1 3/4"
TF1420-178SHC-01	1 7/8"
TF1420-21SHC-01	2"
TF1420-218SHC-01	2 1/8"
TF1420-214SHC-01	2 1/4"
TF1420-238SHC-01	2 3/8"
TF1420-212SHC-01	2 1/2"

Part Numbers listed on this page are made from **Dupont 210 (ETFE)**.
Available material grades are:
Dupont PFA 230 (PTFE) – TFA (ex. **TFA440-78PHP-01**)

Part Number ending in **-01** is for natural Teflon.
Standard colors are: **-02** Black, **-03** Blue, **-04** Red, **-05** Green, **-06** Yellow,
-07 White.

Other sizes, types, colors, and color matches available as special orders.
Please call for details.

1/4-28 Socket Head

Part No. Length (a)

Machine Screw, Socket Head,
1/4-20 Threadb = 0.25
c = 0.37
d = 0.19
e = 0.16

TF1420-14SHC-01	1/4"
TF1420-38SHC-01	3/8"
TF1420-12SHC-01	1/2"
TF1420-58SHC-01	5/8"
TF1420-34SHC-01	3/4"
TF1420-78SHC-01	7/8"
TF1420-11SHC-01	1"
TF1420-118SHC-01	1 1/8"
TF1420-114SHC-01	1 1/4"
TF1420-138SHC-01	1 3/8"
TF1420-112SHC-01	1 1/2"
TF1420-158SHC-01	1 5/8"
TF1420-134SHC-01	1 3/4"
TF1420-178SHC-01	1 7/8"
TF1420-21SHC-01	2"
TF1420-218SHC-01	2 1/8"
TF1420-214SHC-01	2 1/4"
TF1420-238SHC-01	2 3/8"
TF1420-212SHC-01	2 1/2"

3/8-16 Socket Head

Part No. Length (a)

Machine Screw, Socket Head,
3/8 16 Threadb = 0.37
c = 0.56
d = 0.31
e = 0.27

TF3816-14SHC-01	1/4"
TF3816-38SHC-01	3/8"
TF3816-12SHC-01	1/2"
TF3816-58SHC-01	5/8"
TF3816-34SHC-01	3/4"
TF3816-78SHC-01	7/8"
TF3816-11SHC-01	1"
TF3816-118SHC-01	1 1/8"
TF3816-114SHC-01	1 1/4"
TF3816-138SHC-01	1 3/8"
TF3816-112SHC-01	1 1/2"
TF3816-158SHC-01	1 5/8"
TF3816-134SHC-01	1 3/4"
TF3816-178SHC-01	1 7/8"
TF3816-21SHC-01	2"
TF3816-218SHC-01	2 1/8"
TF3816-214SHC-01	2 1/4"
TF3816-238SHC-01	2 3/8"
TF3816-212SHC-01	2 1/2"

5/16-18 Socket Head

Part No. Length (a)

Machine Screw, Socket Head,
5/16-18 Threadb = 0.31
c = 0.46
d = 0.25
e = 0.20

TF51618-14SHC-01	1/4"
TF51618-38SHC-01	3/8"
TF51618-12SHC-01	1/2"
TF51618-58SHC-01	5/8"
TF51618-34SHC-01	3/4"
TF51618-78SHC-01	7/8"
TF51618-11SHC-01	1"
TF51618-118SHC-01	1 1/8"
TF51618-114SHC-01	1 1/4"
TF51618-138SHC-01	1 3/8"
TF51618-112SHC-01	1 1/2"
TF51618-158SHC-01	1 5/8"
TF51618-134SHC-01	1 3/4"
TF51618-178SHC-01	1 7/8"
TF51618-21SHC-01	2"
TF51618-218SHC-01	2 1/8"
TF51618-214SHC-01	2 1/4"
TF51618-238SHC-01	2 3/8"
TF51618-212SHC-01	2 1/2"

3/8-24 Socket Head

Part No. Length (a)

Machine Screw, Socket Head,
3/8-24 Threadb = 0.37
c = 0.56
d = 0.31
e = 0.27

TF3824-14SHC-01	1/4"
TF3824-38SHC-01	3/8"
TF3824-12SHC-01	1/2"
TF3824-58SHC-01	5/8"
TF3824-34SHC-01	3/4"
TF3824-78SHC-01	7/8"
TF3824-11SHC-01	1"
TF3824-118SHC-01	1 1/8"
TF3824-114SHC-01	1 1/4"
TF3824-138SHC-01	1 3/8"
TF3824-112SHC-01	1 1/2"
TF3824-158SHC-01	1 5/8"
TF3824-134SHC-01	1 3/4"
TF3824-178SHC-01	1 7/8"
TF3824-21SHC-01	2"
TF3824-218SHC-01	2 1/8"
TF3824-214SHC-01	2 1/4"
TF3824-238SHC-01	2 3/8"
TF3824-212SHC-01	2 1/2"

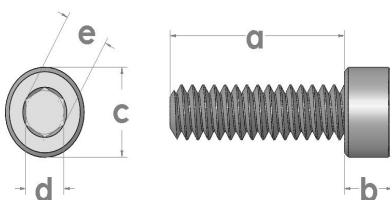
Part Numbers listed on this page are made from **Dupont 210 (ETFE)**.

Available material grades are:

Dupont PFA 230 (PTFE) – TFA (ex. **TFA440-78PHP-01**)Part Number ending in **-01** is for natural Teflon.Standard colors are: **-02** Black, **-03** Blue, **-04** Red, **-05** Green, **-06** Yellow,
-07 White.Other sizes, types, colors, and color matches available as special orders.
Please call for details.

6-32 Nuts	Number	Color
Machine Nuts, 6-32 Thread	TF632-NTS-01	Natural
	TF632-NTS-02	Black
	TF632-NTS-03	Blue
	TF632-NTS-04	Red
	TF632-NTS-05	Green
	TF632-NTS-06	Yellow

$a = 6-32$
 $b = 0.32$
 $c = 0.12$
 $d = 0.36$

3/8-16 Nuts	Number	Color
Machine Nuts, 3/8-16 Thread,	TF3816-NTS-01	Natural
	TF3816-NTS-02	Black
	TF3816-NTS-03	Blue
	TF3816-NTS-04	Red
	TF3816-NTS-05	Green
	TF3816-NTS-06	Yellow

$a = 3/8-16$
 $b = 0.62$
 $c = 0.25$
 $d = 0.72$

8-32 Nuts	Number	Color
Machine Nuts, 8-32 Thread	TF832-NTS-01	Natural
	TF832-NTS-02	Black
	TF832-NTS-03	Blue
	TF832-NTS-04	Red
	TF832-NTS-05	Green
	TF832-NTS-06	Yellow

$a = 8-32$
 $b = 0.35$
 $c = 0.13$
 $d = 0.40$

Ca Series, Carbon Filled	Number	Color
PEEK Machine Nuts, Carbon filled.*	TF632-NTS-Ca	Black
	TF832-NTS-Ca	Black
	TF1032-NTS-Ca	Black
	TF1420-NTS-Ca	Black
	TF51618-NTS-Ca	Black
	TF3816-NTS-Ca	Black

10-32 Nuts	Number	Color
Machine Nuts, 10-32 Thread,	TF1032-NTS-01	Natural
	TF1032-NTS-02	Black
	TF1032-NTS-03	Blue
	TF1032-NTS-04	Red
	TF1032-NTS-05	Green
	TF1032-NTS-06	Yellow

$a = 10-32$
 $b = 0.38$
 $c = 0.13$
 $d = 0.43$

1/4-20 Nuts	Number	Color
Machine Nuts, 1/4-20 Thread	TF1420-NTS-01	Natural
	TF1420-NTS-02	Black
	TF1420-NTS-03	Blue
	TF1420-NTS-04	Red
	TF1420-NTS-05	Green
	TF1420-NTS-06	Yellow

$a = 1/4-20$
 $b = 0.44$
 $c = 0.18$
 $d = 0.48$

5/16-18 Nuts	Number	Color
Machine Nuts, 5/16-18 Thread	TF51618-NTS-01	Natural
	TF51618-NTS-02	Black
	TF51618-NTS-03	Blue
	TF51618-NTS-04	Red
	TF51618-NTS-05	Green
	TF51618-NTS-06	Yellow

$a = 5/16-18$
 $b = 0.56$
 $c = 0.22$
 $d = 0.64$

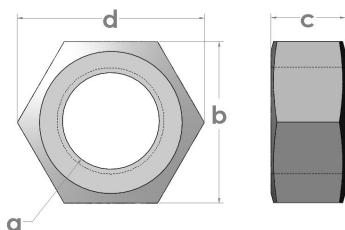

Part Numbers listed on this page are made from **Dupont 210 (ETFE)**. Available material grades are:
Dupont PFA 230 (PTFE) – TFA (ex. **TFA440-78PHP-01**)

Part Number ending in **-01** is for natural Teflon.
 Standard colors are: **-02** Black, **-03** Blue, **-04** Red, **-05** Green, **-06** Yellow, **-07** White.

Other sizes, types, colors, and color matches available as special orders. Please call for details.

#6 Washer	Number	Color
Machine Washers, #6 a = 0.375 b = 0.082 c = 0.268	TF6-WHS-01	Natural
	TF6-WHS-02	Black
	TF6-WHS-03	Blue
	TF6-WHS-04	Red
	TF6-WHS-05	Green
	TF6-WHS-06	Yellow

3/8 Washer	Number	Color
Machine Washers, 3/8" a = 0.500 b = 0.096 c = 0.314	TF38-WHS-01	Natural
	TF38-WHS-02	Black
	TF38-WHS-03	Blue
	TF38-WHS-04	Red
	TF38-WHS-05	Green
	TF38-WHS-06	Yellow

#8 Washer	Number	Color
Machine Washers, #8 a = 0.500 b = 0.082 c = 0.268	TF8-WHS-01	Natural
	TF8-WHS-02	Black
	TF8-WHS-03	Blue
	TF8-WHS-04	Red
	TF8-WHS-05	Green
	TF8-WHS-06	Yellow

Ca Series, Carbon Filled	Number	Color
PEEK Machine Washers, Carbon filled.*	TF6-WHS-Ca	Black
	TF8-WHS-Ca	Black
	TF10-WHS-Ca	Black
	TF14-WHS-Ca	Black
	TF516-WHS-Ca	Black
	TF38-WHS-Ca	Black

* Carbon filled screws are available in all sizes listed on this page. Carbon filling is used instead of glass and has added benefits such as static conductivity, increased strength and rigidity. Carbon filled screws come only in black.

#10 Washer	Number	Color
Machine Washers, #10 a = 0.750 b = 0.082 c = 0.268	TF10-WHS-01	Natural
	TF10-WHS-02	Black
	TF10-WHS-03	Blue
	TF10-WHS-04	Red
	TF10-WHS-05	Green
	TF10-WHS-06	Yellow

1/4 Washer	Number	Color
Machine Washers, 1/4" a = 0.375 b = 0.096 c = 0.314	TF14-WHS-01	Natural
	TF14-WHS-02	Black
	TF14-WHS-03	Blue
	TF14-WHS-04	Red
	TF14-WHS-05	Green
	TF14-WHS-06	Yellow

5/16 Washer	Number	Color
Machine Washers, 5/16" a = 0.500 b = 0.096 c = 0.314	TF516-WHS-01	Natural
	TF516-WHS-02	Black
	TF516-WHS-03	Blue
	TF516-WHS-04	Red
	TF516-WHS-05	Green
	TF516-WHS-06	Yellow

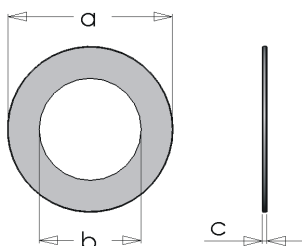

Part Numbers listed on this page are made from **Dupont 210 (ETFE)**. Available material grades are:
Dupont PFA 230 (PTFE) – TFA (ex. TFA440-78PHP-01)

Part Number ending in **-01** is for natural Teflon.
Standard colors are: **-02** Black, **-03** Blue, **-04** Red, **-05** Green, **-06** Yellow, **-07** White.

Other sizes, types, colors, and color matches available as special orders. Please call for details.

150 Faxable Order Form

Shipping:

Company: _____
 Attn: _____
 Address: _____
 City: _____ State/Province: _____
 Post Office Code: _____ Country: _____
 Phone: _____ Fax: _____
 Email: _____
 PO #: _____

Billing: (If different from shipping.)

Company: _____
 Attn: _____
 Address: _____
 City: _____ State/Province: _____
 Post Office Code: _____ Country: _____
 Phone: _____ Fax: _____
 Email: _____

TEI does not accept returns, except on defective product. All returns require an RA (Return Authorization) issued from TEI.

Part #	Date Required	Description	Quantity	Unit
Cost	Total			
2				
3				
4				
5				
6				
7				
8				
9				
10				
11				
12				
13				
14				
15				
16				

Fax this form at 847.816.0130 of mail to:
 Technique Eng., Inc.
 13950 Polo Trail Dr.
 Lake Forest, IL 60045-5013
 Attn: Orders

Subtotal: _____
 State Tax: _____
 resale certificate must be on file
 Shipping: _____
 call for details

GRAND TOTAL: _____

	Carrier	Service	Account Number
Shipping	UPS	Ground	_____
	FEDEX	2nd Day	
	DHL	Next Day	
Options:	Other: _____	Worldwide	Optional