

PEEK Screws

Pan Head Phillips.....4-5
 Pan Head Slotted.....6-8
 Flat Head Phillips.....9-10
 Flat Head Slotted.....11-13
 Hex Head.....14-16
 Socket Head cap.....17-18

PEEK Nuts

Machine19

PEEK Washers

Machine.....20

PEEK Screws Metric

Pan Head Phillips.....21-22
 Pan Head Slotted.....23-24
 Flat Head Phillips.....25-26
 Flat Head Slotted.....27-28
 Cheese Head Phillips.....29-30
 Cheese Head Slotted.....31-32
 Hex Head.....33-34
 Socket Head Cap.....35-36

PEEK Washers

Machine.....37

PEEK Bearings

Stainless Inserted.....38
 Flanged Sleeve.....39
 Sleeve.....40

ETFE/PTFE (Teflon) Screws

Pan Head Phillips.....41-42
 Pan Head Slotted.....43-45
 Flat Head Phillips.....46-47
 Flat Head Slotted.....48-50
 Hex Head.....51-53
 Socket Head cap.....54-56

ETFE/PTFE (Teflon) Nuts

Machine57

ETFE/PTFE (Teflon) Washers

Machine.....58

ETFE/PTFE (Teflon) Screws Metric

Pan Head Phillips.....59-60
 Pan Head Slotted.....61-62
 Flat Head Phillips.....63-64
 Flat Head Slotted.....65-66
 Cheese Head Phillips.....67-68
 Cheese Head Slotted.....69-70
 Socket Head Cap.....71-72

ETFE/PTFE (Teflon) Washers Metric

Machine73

Ultem Screws

Pan Head Phillips.....87-88
 Pan Head Slotted.....89-91
 Flat Head Phillips.....92-93
 Flat Head Slotted.....94-96
 Hex Head.....97-99
 Socket Head cap.....100-101

Ultem Nuts

Machine102

Ultem Washers

Machine.....103

Ultem Screws Metric

Pan Head Phillips.....104-106
 Pan Head Slotted.....107-109
 Flat Head Phillips.....110-112
 Flat Head Slotted.....113-115
 Cheese Head Phillips.....116-118
 Cheese Head Slotted.....119-121
 Socket Head Cap.....122-124

Ultem Nuts Metric

Machine125

Ultem Washers

Machine.....126

TEI's PEEK Fasteners

- *Extremely stable in hostile environments.
Hydrolysis resistant. Withstands water and steam without loss of physical properties.
- *Insoluble in all common solvents. Excellent resistance to a very wide range of organic and inorganic liquids, like acids, bases, salts and steam.
- *Continuous service temperature of 500°F (260°C). Mechanical properties retained to temperatures over 570°F (300°C).
- *Wear resistant.
- *Impact resistant.
- *Radiation resistant.
- *UL-V-0 flammability rating.
- *Rockwell hardness is M103.
- *All unfilled grades comply with the compositional requirements of FDA regulation 21CFR 177.2415 for repeated use in contact with food.
- * Lower moisture absorption than nylons and other polymers.

Cost Effective

- *Replacement for aluminum, steel and stainless steel screws.
- *Light weight.
- *Injection molded so stronger than machined screws.

ISO Design and Production Standards

- *TEI. is an ISO 9001:2008 registered company.
- *All dimensions follow the Machinery's Handbook 29th Edition, 2012 printing.



PEEK Pan Head Phillips Screws

4-40 Pan Head Phillips	Part No.	Length (a)
Machine Screw, Pan Head Phillips, 4-40 Thread	PK440-14PHP-01	1/4"
	PK440-38PHP-01	3/8"
	PK440-12PHP-01	1/2"
	PK440-58PHP-01	5/8"
	PK440-34PHP-01	3/4"
	PK440-78PHP-01	7/8"
	PK440-11PHP-01	1"

b = 0.05
c = 0.21

6-32 Pan Head Phillips	Part No.	Length (a)
Machine Screw, Pan Head Phillips, 6-32 Thread	PK632-14PHP-01	1/4"
	PK632-38PHP-01	3/8"
	PK632-12PHP-01	1/2"
	PK632-58PHP-01	5/8"
	PK632-34PHP-01	3/4"
	PK632-78PHP-01	7/8"
	PK632-11PHP-01	1"
	PK632-118PHP-01	1 1/8"
	PK632-114PHP-01	1 1/4"

b = 0.08
c = 0.27

8-32 Pan Head Phillips	Part No.	Length (a)
Machine Screw, Pan Head Phillips, 8-32 Thread	PK832-14PHP-01	1/4"
	PK832-38PHP-01	3/8"
	PK832-12PHP-01	1/2"
	PK832-58PHP-01	5/8"
	PK832-34PHP-01	3/4"
	PK832-78PHP-01	7/8"
	PK832-11PHP-01	1"
	PK832-118PHP-01	1 1/8"
	PK832-114PHP-01	1 1/4"
	PK832-138PHP-01	1 3/8"

b = 0.10
c = 0.32

10-24 Pan Head Phillips	Part No.	Length (a)
Machine Screw, Pan Head Phillips, 8-32 Thread	PK1024-14PHP-01	1/4"
	PK1024-38PHP-01	3/8"
	PK1024-12PHP-01	1/2"
	PK1024-58PHP-01	5/8"
	PK1024-34PHP-01	3/4"
	PK1024-78PHP-01	7/8"
	PK1024-11PHP-01	1"
	PK1024-118PHP-01	1 1/8"
	PK1024-114PHP-01	1 1/4"
	PK1024-138PHP-01	1 3/8"
	PK1024-112PHP-01	1 1/2"
	PK1024-158PHP-01	1 5/8"
	PK1024-134PHP-01	1 3/4"
	PK1024-178PHP-01	1 7/8"
	PK1024-21PHP-01	2"

b = 0.11
c = 0.37

10-32 Pan Head Phillips	Part No.	Length (a)
Machine Screw, Pan Head Phillips, 10-32 Thread	PK1032-14PHP-01	1/4"
	PK1032-38PHP-01	3/8"
	PK1032-12PHP-01	1/2"
	PK1032-58PHP-01	5/8"
	PK1032-34PHP-01	3/4"
	PK1032-78PHP-01	7/8"
	PK1032-11PHP-01	1"
	PK1032-118PHP-01	1 1/8"
	PK1032-114PHP-01	1 1/4"
	PK1032-138PHP-01	1 3/8"
	PK1032-112PHP-01	1 1/2"
	PK1032-158PHP-01	1 5/8"
	PK1032-134PHP-01	1 3/4"

b = 0.11
c = 0.37

1/4-20 Pan Head Phillips	Part No.	Length (a)
Machine Screw, Pan Head Phillips, 1/4-20 Thread	PK1420-14PHP-01	1/4"
	PK1420-38PHP-01	3/8"
	PK1420-12PHP-01	1/2"
	PK1420-58PHP-01	5/8"
	PK1420-34PHP-01	3/4"
	PK1420-78PHP-01	7/8"
	PK1420-11PHP-01	1"
	PK1420-118PHP-01	1 1/8"
	PK1420-114PHP-01	1 1/4"
	PK1420-138PHP-01	1 3/8"
	PK1420-112PHP-01	1 1/2"
	PK1420-158PHP-01	1 5/8"
	PK1420-134PHP-01	1 3/4"
	PK1420-178PHP-01	1 7/8"
	PK1420-21PHP-01	2"
	PK1420-218PHP-01	2 1/8"

b = 0.14
c = 0.49

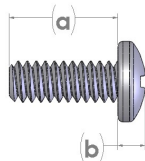

Part Numbers listed on this page are made from **30% Glass Filled PEEK**. Available material grades are:
 30% Carbon Filled – **Ca** (ex. PK440-78PHP-**Ca**)
 Unfilled PEEK – **UF01** (ex. PK440-78PHP-**UF01**)
 High Temperature PEEK, 30% Glass Filled– **HT01** (ex. PK440-78PHP-**HT01**)
 High Temperature PEEK, 30% Carbon Filled – **HTCa** (ex. PK440-78PHP-**HTCa**)

Part Number ending in **-01** is for natural PEEK.
 Standard colors are: **-02** Black, **-03** Blue, **-04** Red, **-05** Green, **-06** Yellow.
 Other sizes, types, colors, and color matches available as special orders. Please call for details.



1/4-28 Pan Head Phillips	Part No.	Length (a)
Machine Screw, Pan Head Phillips, 1/4-28 Thread b = 0.14 c = 0.49	PK1428-14PHP-01	1/4"
	PK1428-38PHP-01	3/8"
	PK1428-12PHP-01	1/2"
	PK1428-58PHP-01	5/8"
	PK1428-34PHP-01	3/4"
	PK1428-78PHP-01	7/8"
	PK1428-11PHP-01	1"
	PK1428-118PHP-01	1 1/8"
	PK1428-114PHP-01	1 1/4"
	PK1428-138PHP-01	1 3/8"
	PK1428-112PHP-01	1 1/2"
	PK1428-158PHP-01	1 5/8"
	PK1428-134PHP-01	1 3/4"
	PK1428-178PHP-01	1 7/8"
	PK1428-21PHP-01	2"
	PK1428-218PHP-01	2 1/8"
	PK1428-214PHP-01	2 1/4"
	PK1428-238PHP-01	2 3/8"
	PK1428-212PHP-01	2 1/2"

5/16-18 Pan Head Phillips	Part No.	Length (a)
Machine Screw, Pan Head Phillips, 5/16-18 Thread b = 0.17 c = 0.60	PK51618-14PHP-01	1/4"
	PK51618-38PHP-01	3/8"
	PK51618-12PHP-01	1/2"
	PK51618-58PHP-01	5/8"
	PK51618-34PHP-01	3/4"
	PK51618-78PHP-01	7/8"
	PK51618-11PHP-01	1"
	PK51618-118PHP-01	1 1/8"
	PK51618-114PHP-01	1 1/4"
	PK51618-138PHP-01	1 3/8"
	PK51618-112PHP-01	1 1/2"
	PK51618-158PHP-01	1 5/8"
	PK51618-134PHP-01	1 3/4"
	PK51618-178PHP-01	1 7/8"
	PK51618-21PHP-01	2"
	PK51618-218PHP-01	2 1/8"
	PK51618-214PHP-01	2 1/4"
	PK51618-238PHP-01	2 3/8"
	PK51618-212PHP-01	2 1/2"

3/8-16 Pan Head Phillips	Part No.	Length (a)
Machine Screw, Pan Head Phillips, 3/8 16 Thread b = 0.20 c = 0.73	PK3816-14PHP-01	1/4"
	PK3816-38PHP-01	3/8"
	PK3816-12PHP-01	1/2"
	PK3816-58PHP-01	5/8"
	PK3816-34PHP-01	3/4"
	PK3816-78PHP-01	7/8"
	PK3816-11PHP-01	1"
	PK3816-118PHP-01	1 1/8"
	PK3816-114PHP-01	1 1/4"
	PK3816-138PHP-01	1 3/8"
	PK3816-112PHP-01	1 1/2"
	PK3816-158PHP-01	1 5/8"
	PK3816-134PHP-01	1 3/4"
	PK3816-178PHP-01	1 7/8"
	PK3816-21PHP-01	2"
	PK3816-218PHP-01	2 1/8"
	PK3816-214PHP-01	2 1/4"
	PK3816-238PHP-01	2 3/8"
	PK3816-212PHP-01	2 1/2"

3/8-24 Pan Head Phillips	Part No.	Length (a)
Machine Screw, Pan Head Phillips, 3/8-24 Thread b = 0.20 c = 0.73	PK3824-14PHP-01	1/4"
	PK3824-38PHP-01	3/8"
	PK3824-12PHP-01	1/2"
	PK3824-58PHP-01	5/8"
	PK3824-34PHP-01	3/4"
	PK3824-78PHP-01	7/8"
	PK3824-11PHP-01	1"
	PK3824-118PHP-01	1 1/8"
	PK3824-114PHP-01	1 1/4"
	PK3824-138PHP-01	1 3/8"
	PK3824-112PHP-01	1 1/2"
	PK3824-158PHP-01	1 5/8"
	PK3824-134PHP-01	1 3/4"
	PK3824-178PHP-01	1 7/8"
	PK3824-21PHP-01	2"
	PK3824-218PHP-01	2 1/8"
	PK3824-214PHP-01	2 1/4"
	PK3824-238PHP-01	2 3/8"
	PK3824-212PHP-01	2 1/2"

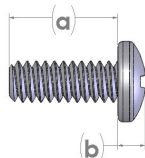

Part Numbers listed on this page are made from **30% Glass Filled PEEK**.

Available material grades are:

30% Carbon Filled – **Ca** (ex. PK440-78PHP-**Ca**)

Unfilled PEEK – **UF01** (ex. PK440-78PHP-**UF01**)

High Temperature PEEK, 30% Glass Filled– **HT01** (ex. PK440-78PHP-**HT01**)

High Temperature PEEK, 30% Carbon Filled – **HTCa** (ex. PK440-78PHP-**HTCa**)

Part Number ending in **-01** is for natural PEEK.

Standard colors are: **-02** Black, **-03** Blue, **-04** Red, **-05** Green, **-06** Yellow.

Other sizes, types, colors, and color matches available as special orders.
Please call for details.



PEEK Pan Head Slotted Screws

0-80 Pan Head Slotted

Machine Screw, Pan Head Slotted,
0-80 Thread

b = 0.03
c = 0.09

Part No.	Length (a)
PK080-14PHS-01	1/4"
PK080-38PHS-01	3/8"
PK080-12PHS-01	1/2"

2-56 Pan Head Slotted

Machine Screw, Pan Head Slotted,
2-56 Thread

b = 0.03
c = 0.16

Part No.	Length (a)
PK256-14PHS-01	1/4"
PK256-38PHS-01	3/8"
PK256-12PHS-01	1/2"

4-40 Pan Head Slotted

Machine Screw, Pan Head Slotted,
4-40 Thread

b = 0.08
c = 0.21

Part No.	Length (a)
PK440-14PHS-01	1/4"
PK440-38PHS-01	3/8"
PK440-12PHS-01	1/2"
PK440-58PHS-01	5/8"
PK440-34PHS-01	3/4"
PK440-78PHS-01	7/8"
PK440-11PHS-01	1"

6-32 Pan Head Slotted

Machine Screw, Pan Head Slotted,
6-32 Thread

b = 0.09
c = 0.27

Part No.	Length (a)
PK632-14PHS-01	1/4"
PK632-38PHS-01	3/8"
PK632-12PHS-01	1/2"
PK632-58PHS-01	5/8"
PK632-34PHS-01	3/4"
PK632-78PHS-01	7/8"
PK632-11PHS-01	1"
PK632-118PHS-01	1 1/8"
PK632-114PHS-01	1 1/4"

8-32 Pan Head Slotted

Machine Screw, Pan Head Slotted,
8-32 Thread

b = 0.09
c = 0.32

Part No.	Length (a)
PK832-14PHS-01	1/4"
PK832-38PHS-01	3/8"
PK832-12PHS-01	1/2"
PK832-58PHS-01	5/8"
PK832-34PHS-01	3/4"
PK832-78PHS-01	7/8"
PK832-11PHS-01	1"
PK832-118PHS-01	1 1/8"
PK832-114PHS-01	1 1/4"
PK832-138PHS-01	1 3/8"
PK832-112PHS-01	1 1/2"

10-24 Pan Head Slotted

Machine Screw, Pan Head Slotted,
10-24 Thread

b = 0.10
c = 0.37

Part No.	Length (a)
PK1024-14PHS-01	1/4"
PK1024-38PHS-01	3/8"
PK1024-12PHS-01	1/2"
PK1024-58PHS-01	5/8"
PK1024-34PHS-01	3/4"
PK1024-78PHS-01	7/8"
PK1024-11PHS-01	1"
PK1024-118PHS-01	1 1/8"
PK1024-114PHS-01	1 1/4"
PK1024-138PHS-01	1 3/8"
PK1024-112PHS-01	1 1/2"
PK1024-158PHS-01	1 5/8"
PK1024-134PHS-01	1 3/4"
PK1024-178PHS-01	1 7/8"
PK1024-21PHS-01	2"

10-32 Pan Head Slotted

Machine Screw, Pan Head Slotted,
10-32 Thread

b = 0.10
c = 0.37

Part No.	Length (a)
PK1032-14PHS-01	1/4"
PK1032-38PHS-01	3/8"
PK1032-12PHS-01	1/2"
PK1032-58PHS-01	5/8"
PK1032-34PHS-01	3/4"
PK1032-78PHS-01	7/8"
PK1032-11PHS-01	1"
PK1032-118PHS-01	1 1/8"
PK1032-114PHS-01	1 1/4"
PK1032-138PHS-01	1 3/8"
PK1032-112PHS-01	1 1/2"
PK1032-158PHS-01	1 5/8"
PK1032-134PHS-01	1 3/4"
PK1032-178PHS-01	1 7/8"
PK1032-21PHS-01	2"

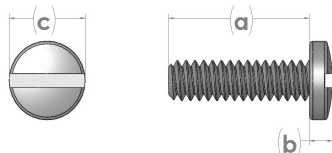

Part Numbers listed on this page are made from **30% Glass Filled PEEK**. Available material grades are:
 30% Carbon Filled – **-Ca** (ex. PK440-78PHP-**-Ca**)
 Unfilled PEEK – **-UF01** (ex. PK440-78PHP-**-UF01**)
 High Temperature PEEK, 30% Glass Filled– **-HT01** (ex. PK440-78PHP-**-HT01**)
 High Temperature PEEK, 30% Carbon Filled – **-HTCa** (ex. PK440-78PHP-**-HTCa**)

Part Number ending in **-01** is for natural PEEK.
 Standard colors are: **-02** Black, **-03** Blue, **-04** Red, **-05** Green, **-06** Yellow.
 Other sizes, types, colors, and color matches available as special orders. Please call for details.



1/4-20 Pan Head Slotted	Part No.	Length (a)
Machine Screw, Pan Head Slotted, 1/4-20 Thread b = 0.13 c = 0.37	PK1420-14PHS-01	1/4"
	PK1420-38PHS-01	3/8"
	PK1420-12PHS-01	1/2"
	PK1420-58PHS-01	5/8"
	PK1420-34PHS-01	3/4"
	PK1420-78PHS-01	7/8"
	PK1420-11PHS-01	1"
	PK1420-118PHS-01	1 1/8"
	PK1420-114PHS-01	1 1/4"
	PK1420-138PHS-01	1 3/8"
	PK1420-112PHS-01	1 1/2"
	PK1420-158PHS-01	1 5/8"
	PK1420-134PHS-01	1 3/4"
	PK1420-178PHS-01	1 7/8"
	PK1420-21PHS-01	2"
	PK1420-218PHS-01	2 1/8"
	PK1420-214PHS-01	2 1/4"
	PK1420-238PHS-01	2 3/8"
	PK1420-212PHS-01	2 1/2"

1/4-28 Pan Head Slotted	Part No.	Length (a)
Machine Screw, Pan Head Slotted, 1/4-28 Thread b = 0.13 c = 0.37	PK1428-14PHS-01	1/4"
	PK1428-38PHS-01	3/8"
	PK1428-12PHS-01	1/2"
	PK1428-58PHS-01	5/8"
	PK1428-34PHS-01	3/4"
	PK1428-78PHS-01	7/8"
	PK1428-11PHS-01	1"
	PK1428-118PHS-01	1 1/8"
	PK1428-114PHS-01	1 1/4"
	PK1428-138PHS-01	1 3/8"
	PK1428-112PHS-01	1 1/2"
	PK1428-158PHS-01	1 5/8"
	PK1428-134PHS-01	1 3/4"
	PK1428-178PHS-01	1 7/8"
	PK1428-21PHS-01	2"
	PK1428-218PHS-01	2 1/8"
	PK1428-214PHS-01	2 1/4"
	PK1428-238PHS-01	2 3/8"
	PK1428-212PHS-01	2 1/2"

5/16-18 Pan Head Slotted	Part No.	Length (a)
Machine Screw, Pan Head Slotted, 5/16-18 Thread b = 0.17 c = 0.60	PK51618-14PHS-01	1/4"
	PK51618-38PHS-01	3/8"
	PK51618-12PHS-01	1/2"
	PK51618-58PHS-01	5/8"
	PK51618-34PHS-01	3/4"
	PK51618-78PHS-01	7/8"
	PK51618-11PHS-01	1"
	PK51618-118PHS-01	1 1/8"
	PK51618-114PHS-01	1 1/4"
	PK51618-138PHS-01	1 3/8"
	PK51618-112PHS-01	1 1/2"
	PK51618-158PHS-01	1 5/8"
	PK51618-134PHS-01	1 3/4"
	PK51618-178PHS-01	1 7/8"
	PK51618-21PHS-01	2"
	PK51618-218PHS-01	2 1/8"
	PK51618-214PHS-01	2 1/4"
	PK51618-238PHS-01	2 3/8"
	PK51618-212PHS-01	2 1/2"

3/8-16 Pan Head Slotted	Part No.	Length (a)
Machine Screw, Pan Head Slotted, 3/8 16 Thread b = 0.20 c = 0.73	PK3816-14PHS-01	1/4"
	PK3816-38PHS-01	3/8"
	PK3816-12PHS-01	1/2"
	PK3816-58PHS-01	5/8"
	PK3816-34PHS-01	3/4"
	PK3816-78PHS-01	7/8"
	PK3816-11PHS-01	1"
	PK3816-118PHS-01	1 1/8"
	PK3816-114PHS-01	1 1/4"
	PK3816-138PHS-01	1 3/8"
	PK3816-112PHS-01	1 1/2"
	PK3816-158PHS-01	1 5/8"
	PK3816-134PHS-01	1 3/4"
	PK3816-178PHS-01	1 7/8"
	PK3816-21PHS-01	2"
	PK3816-218PHS-01	2 1/8"
	PK3816-214PHS-01	2 1/4"
	PK3816-238PHS-01	2 3/8"
	PK3816-212PHS-01	2 1/2"

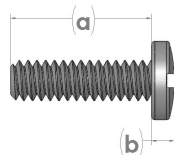
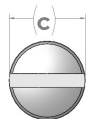

Part Numbers listed on this page are made from **30% Glass Filled PEEK**.

Available material grades are:

30% Carbon Filled – **Ca** (ex. PK440-78PHP-**Ca**)

Unfilled PEEK – **UF01** (ex. PK440-78PHP-**UF01**)

High Temperature PEEK, 30% Glass Filled– **HT01** (ex. PK440-78PHP-**HT01**)

High Temperature PEEK, 30% Carbon Filled – **HTCa** (ex. PK440-78PHP-**HTCa**)

Part Number ending in **-01** is for natural PEEK.

Standard colors are: **-02** Black, **-03** Blue, **-04** Red, **-05** Green, **-06** Yellow.

Other sizes, types, colors, and color matches available as special orders.
Please call for details.



PEEK Pan Head Slotted Screws

3/8-24 Pan Head Slotted

Machine Screw, Pan Head Slotted,
3/8-24 Thread

b = 0.20
c = 0.73

Part No.	Length (a)
PK3824-14PHS-01	1/4"
PK3824-38PHS-01	3/8"
PK3824-12PHS-01	1/2"
PK3824-58PHS-01	5/8"
PK3824-34PHS-01	3/4"
PK3824-78PHS-01	7/8"
PK3824-11PHS-01	1"
PK3824-118PHS-01	1 1/8"
PK3824-114PHS-01	1 1/4"
PK3824-138PHS-01	1 3/8"
PK3824-112PHS-01	1 1/2"
PK3824-158PHS-01	1 5/8"
PK3824-134PHS-01	1 3/4"
PK3824-178PHS-01	1 7/8"
PK3824-21PHS-01	2"
PK3824-218PHS-01	2 1/8"
PK3824-214PHS-01	2 1/4"
PK3824-238PHS-01	2 3/8"
PK3824-212PHS-01	2 1/2"

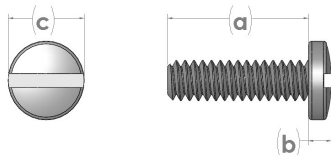

Part Numbers listed on this page are made from **30% Glass Filled PEEK**.
Available material grades are:
30% Carbon Filled – **Ca** (ex. PK440-78PHP-**Ca**)
Unfilled PEEK – **UF01** (ex. PK440-78PHP-**UF01**)
High Temperature PEEK, 30% Glass Filled – **HT01** (ex. PK440-78PHP-**HT01**)
High Temperature PEEK, 30% Carbon Filled – **HTCa** (ex. PK440-78PHP-**HTCa**)

Part Number ending in **-01** is for natural PEEK.
Standard colors are: **-02** Black, **-03** Blue, **-04** Red, **-05** Green, **-06** Yellow.
Other sizes, types, colors, and color matches available as special orders.
Please call for details.



4-40 Flat Head Phillips	Part No.	Length (a)
Machine Screw, Flat Head Phillips, 4-40 Thread	PK440-14FHP-01	1/4"
	PK440-38FHP-01	3/8"
	PK440-12FHP-01	1/2"
	PK440-58FHP-01	5/8"
	PK440-34FHP-01	3/4"
	PK440-78FHP-01	7/8"
	PK440-11FHP-01	1"

b = 0.05
c = 0.19

6-32 Flat Head Phillips	Part No.	Length (a)
Machine Screw, Flat Head Phillips, 6-32 Thread	PK632-14FHP-01	1/4"
	PK632-38FHP-01	3/8"
	PK632-12FHP-01	1/2"
	PK632-58FHP-01	5/8"
	PK632-34FHP-01	3/4"
	PK632-78FHP-01	7/8"
	PK632-11FHP-01	1"
	PK632-118FHP-01	1 1/8"
	PK632-114FHP-01	1 1/4"

b = 0.08
c = 0.26

8-32 Flat Head Phillips	Part No.	Length (a)
Machine Screw, Flat Head Phillips, 8-32 Thread	PK832-14FHP-01	1/4"
	PK832-38FHP-01	3/8"
	PK832-12FHP-01	1/2"
	PK832-58FHP-01	5/8"
	PK832-34FHP-01	3/4"
	PK832-78FHP-01	7/8"
	PK832-11FHP-01	1"
	PK832-118FHP-01	1 1/8"
	PK832-114FHP-01	1 1/4"
	PK832-138FHP-01	1 3/8"
	PK832-112FHP-01	1 1/2"

b = 0.10
c = 0.31

10-24 Flat Head Phillips	Part No.	Length (a)
Machine Screw, Flat Head Phillips, 8-32 Thread	PK1024-14FHP-01	1/4"
	PK1024-38FHP-01	3/8"
	PK1024-12FHP-01	1/2"
	PK1024-58FHP-01	5/8"
	PK1024-34FHP-01	3/4"
	PK1024-78FHP-01	7/8"
	PK1024-11FHP-01	1"
	PK1024-118FHP-01	1 1/8"
	PK1024-114FHP-01	1 1/4"
	PK1024-138FHP-01	1 3/8"
	PK1024-112FHP-01	1 1/2"
	PK1024-158FHP-01	1 5/8"
	PK1024-134FHP-01	1 3/4"
	PK1024-178FHP-01	1 7/8"
	PK1024-21FHP-01	2"

b = 0.11
c = 0.36

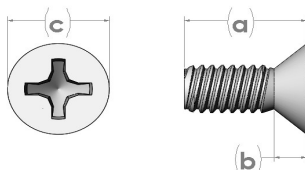

10-32 Flat Head Phillips	Part No.	Length (a)
Machine Screw, Flat Head Phillips, 10-32 Thread	PK1032-14FHP-01	1/4"
	PK1032-38FHP-01	3/8"
	PK1032-12FHP-01	1/2"
	PK1032-58FHP-01	5/8"
	PK1032-34FHP-01	3/4"
	PK1032-78FHP-01	7/8"
	PK1032-11FHP-01	1"
	PK1032-118FHP-01	1 1/8"
	PK1032-114FHP-01	1 1/4"
	PK1032-138FHP-01	1 3/8"
	PK1032-112FHP-01	1 1/2"
	PK1032-158FHP-01	1 5/8"
	PK1032-134FHP-01	1 3/4"
	PK1032-178FHP-01	1 7/8"
PK1032-21FHP-01	2"	

b = 0.11
c = 0.36

1/4-20 Flat Head Phillips	Part No.	Length (a)
Machine Screw, Flat Head Phillips, 1/4-20 Thread	PK1420-14FHP-01	1/4"
	PK1420-38FHP-01	3/8"
	PK1420-12FHP-01	1/2"
	PK1420-58FHP-01	5/8"
	PK1420-34FHP-01	3/4"
	PK1420-78FHP-01	7/8"
	PK1420-11FHP-01	1"
	PK1420-118FHP-01	1 1/8"
	PK1420-114FHP-01	1 1/4"
	PK1420-138FHP-01	1 3/8"
	PK1420-112FHP-01	1 1/2"
	PK1420-158FHP-01	1 5/8"
	PK1420-134FHP-01	1 3/4"
	PK1420-178FHP-01	1 7/8"
	PK1420-21FHP-01	2"
	PK1420-218FHP-01	2 1/8"
	PK1420-214FHP-01	2 1/4"
	PK1420-238FHP-01	2 3/8"
	PK1420-212FHP-01	2 1/2"

b = 0.15
c = 0.48

Part Numbers listed on this page are made from **30% Glass Filled PEEK**.

Available material grades are:

30% Carbon Filled – **Ca** (ex. PK440-78PHP-**Ca**)

Unfilled PEEK – **UF01** (ex. PK440-78PHP-**UF01**)

High Temperature PEEK, 30% Glass Filled– **HT01** (ex. PK440-78PHP-**HT01**)

High Temperature PEEK, 30% Carbon Filled – **HTCa** (ex. PK440-78PHP-**HTCa**)

Part Number ending in **-01** is for natural PEEK.

Standard colors are: **-02** Black, **-03** Blue, **-04** Red, **-05** Green, **-06** Yellow.

Other sizes, types, colors, and color matches available as special orders.
Please call for details.



PEEK Flat Head Phillips Screws

1/4-28 Flat Head Phillips

Machine Screw, Flat Head Phillips,
1/4-28 Thread

b = 0.15
c = 0.48

Part No.	Length (a)
PK1428-14FHP-01	1/4"
PK1428-38FHP-01	3/8"
PK1428-12FHP-01	1/2"
PK1428-58FHP-01	5/8"
PK1428-34FHP-01	3/4"
PK1428-78FHP-01	7/8"
PK1428-11FHP-01	1"
PK1428-118FHP-01	1 1/8"
PK1428-114FHP-01	1 1/4"
PK1428-138FHP-01	1 3/8"
PK1428-112FHP-01	1 1/2"
PK1428-158FHP-01	1 5/8"
PK1428-134FHP-01	1 3/4"
PK1428-178FHP-01	1 7/8"
PK1428-21FHP-01	2"
PK1428-218FHP-01	2 1/8"
PK1428-214FHP-01	2 1/4"
PK1428-238FHP-01	2 3/8"
PK1428-212FHP-01	2 1/2"

3/8-16 Flat Head Phillips

Machine Screw, Flat Head Phillips,
3/8 16 Thread

b = 0.23
c = 0.70

Part No.	Length (a)
PK3816-14FHP-01	1/4"
PK3816-38FHP-01	3/8"
PK3816-12FHP-01	1/2"
PK3816-58FHP-01	5/8"
PK3816-34FHP-01	3/4"
PK3816-78FHP-01	7/8"
PK3816-11FHP-01	1"
PK3816-118FHP-01	1 1/8"
PK3816-114FHP-01	1 1/4"
PK3816-138FHP-01	1 3/8"
PK3816-112FHP-01	1 1/2"
PK3816-158FHP-01	1 5/8"
PK3816-134FHP-01	1 3/4"
PK3816-178FHP-01	1 7/8"
PK3816-21FHP-01	2"
PK3816-218FHP-01	2 1/8"
PK3816-214FHP-01	2 1/4"
PK3816-238FHP-01	2 3/8"
PK3816-212FHP-01	2 1/2"

5/16-18 Flat Head Phillips

Machine Screw, Flat Head Phillips,
5/16-18 Thread

b = 0.19
c = 0.60

Part No.	Length (a)
PK51618-14FHP-01	1/4"
PK51618-38FHP-01	3/8"
PK51618-12FHP-01	1/2"
PK51618-58FHP-01	5/8"
PK51618-34FHP-01	3/4"
PK51618-78FHP-01	7/8"
PK51618-11FHP-01	1"
PK51618-118FHP-01	1 1/8"
PK51618-114FHP-01	1 1/4"
PK51618-138FHP-01	1 3/8"
PK51618-112FHP-01	1 1/2"
PK51618-158FHP-01	1 5/8"
PK51618-134FHP-01	1 3/4"
PK51618-178FHP-01	1 7/8"
PK51618-21FHP-01	2"
PK51618-218FHP-01	2 1/8"
PK51618-214FHP-01	2 1/4"
PK51618-238FHP-01	2 3/8"
PK51618-212FHP-01	2 1/2"

3/8-24 Flat Head Phillips

Machine Screw, Flat Head Phillips,
3/8-24 Thread

b = 0.23
c = 0.70

Part No.	Length (a)
PK3824-14FHP-01	1/4"
PK3824-38FHP-01	3/8"
PK3824-12FHP-01	1/2"
PK3824-58FHP-01	5/8"
PK3824-34FHP-01	3/4"
PK3824-78FHP-01	7/8"
PK3824-11FHP-01	1"
PK3824-118FHP-01	1 1/8"
PK3824-114FHP-01	1 1/4"
PK3824-138FHP-01	1 3/8"
PK3824-112FHP-01	1 1/2"
PK3824-158FHP-01	1 5/8"
PK3824-134FHP-01	1 3/4"
PK3824-178FHP-01	1 7/8"
PK3824-21FHP-01	2"
PK3824-218FHP-01	2 1/8"
PK3824-214FHP-01	2 1/4"
PK3824-238FHP-01	2 3/8"
PK3824-212FHP-01	2 1/2"

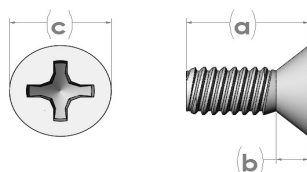

Part Numbers listed on this page are made from **30% Glass Filled PEEK**. Available material grades are:
 30% Carbon Filled – **Ca** (ex. PK440-78PHP-**Ca**)
 Unfilled PEEK – **UF01** (ex. PK440-78PHP-**UF01**)
 High Temperature PEEK, 30% Glass Filled– **HT01** (ex. PK440-78PHP-**HT01**)
 High Temperature PEEK, 30% Carbon Filled – **HTCa** (ex. PK440-78PHP-**HTCa**)

Part Number ending in **-01** is for natural PEEK.
 Standard colors are: **-02** Black, **-03** Blue, **-04** Red, **-05** Green, **-06** Yellow.
 Other sizes, types, colors, and color matches available as special orders. Please call for details.



0-80 Flat Head Slotted	Part No.	Length (a)
Machine Screw, Flat Head Slotted, 0-80 Thread	PK080-14FHS-01	1/4"
	PK080-38FHS-01	3/8"
	PK080-12FHS-01	1/2"

b = 0.04
c = 0.10

2-56 Flat Head Slotted	Part No.	Length (a)
Machine Screw, Flat Head Slotted, 2-56 Thread	PK256-14FHS-01	1/4"
	PK256-38FHS-01	3/8"
	PK256-12FHS-01	1/2"

b = 0.05
c = 0.18

4-40 Flat Head Slotted	Part No.	Length (a)
Machine Screw, Flat Head Slotted, 4-40 Thread	PK440-14FHS-01	1/4"
	PK440-38FHS-01	3/8"
	PK440-12FHS-01	1/2"
	PK440-58FHS-01	5/8"
	PK440-34FHS-01	3/4"
	PK440-78FHS-01	7/8"
	PK440-11FHS-01	1"

b = 0.05
c = 0.19

6-32 Flat Head Slotted	Part No.	Length (a)
Machine Screw, Flat Head Slotted, 6-32 Thread	PK632-14FHS-01	1/4"
	PK632-38FHS-01	3/8"
	PK632-12FHS-01	1/2"
	PK632-58FHS-01	5/8"
	PK632-34FHS-01	3/4"
	PK632-78FHS-01	7/8"
	PK632-11FHS-01	1"
	PK632-118FHS-01	1 1/8"
	PK632-114FHS-01	1 1/4"

b = 0.08
c = 0.26

8-32 Flat Head Slotted	Part No.	Length (a)
Machine Screw, Flat Head Slotted, 8-32 Thread	PK832-14FHS-01	1/4"
	PK832-38FHS-01	3/8"
	PK832-12FHS-01	1/2"
	PK832-58FHS-01	5/8"
	PK832-34FHS-01	3/4"
	PK832-78FHS-01	7/8"
	PK832-11FHS-01	1"
	PK832-118FHS-01	1 1/8"
	PK832-114FHS-01	1 1/4"
	PK832-138FHS-01	1 3/8"
PK832-112FHS-01	1 1/2"	

b = 0.10
c = 0.31

10-24 Flat Head Slotted	Part No.	Length (a)
Machine Screw, Flat Head Slotted, 8-32 Thread	PK1024-14FHS-01	1/4"
	PK1024-38FHS-01	3/8"
	PK1024-12FHS-01	1/2"
	PK1024-58FHS-01	5/8"
	PK1024-34FHS-01	3/4"
	PK1024-78FHP-01	7/8"
	PK1024-11FHS-01	1"
	PK1024-118FHS-01	1 1/8"
	PK1024-114FHS-01	1 1/4"
	PK1024-138FHS-01	1 3/8"
	PK1024-112FHS-01	1 1/2"
	PK1024-158FHS-01	1 5/8"
	PK1024-134FHS-01	1 3/4"
	PK1024-178FH-0S1	1 7/8"
PK1024-21FHS-01	2"	

b = 0.11
c = 0.36

10-32 Flat Head Slotted	Part No.	Length (a)
Machine Screw, Flat Head Slotted, 10-32 Thread	PK1032-14FHS-01	1/4"
	PK1032-38FHS-01	3/8"
	PK1032-12FHS-01	1/2"
	PK1032-58FHS-01	5/8"
	PK1032-34FHS-01	3/4"
	PK1032-78FHS-01	7/8"
	PK1032-11FHS-01	1"
	PK1032-118FHS-01	1 1/8"
	PK1032-114FHS-01	1 1/4"
	PK1032-138FHS-01	1 3/8"
	PK1032-112FHS-01	1 1/2"
	PK1032-158FHS-01	1 5/8"
	PK1032-134FHS-01	1 3/4"
	PK1032-178FHS-01	1 7/8"
	PK1032-21FHS-01	2"

b = 0.11
c = 0.36

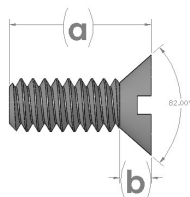
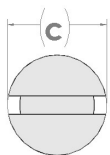

Part Numbers listed on this page are made from **30% Glass Filled PEEK**. Available material grades are:
 30% Carbon Filled – **-Ca** (ex. PK440-78PHP-**Ca**)
 Unfilled PEEK – **-UF01** (ex. PK440-78PHP-**UF01**)
 High Temperature PEEK, 30% Glass Filled– **-HT01** (ex. PK440-78PHP-**HT01**)
 High Temperature PEEK, 30% Carbon Filled – **-HTCa** (ex. PK440-78PHP-**HTCa**)

Part Number ending in **-01** is for natural PEEK.
 Standard colors are: **-02** Black, **-03** Blue, **-04** Red, **-05** Green, **-06** Yellow.
 Other sizes, types, colors, and color matches available as special orders. Please call for details.



PEEK Flat Head Slotted Screws

1/4-20 Flat Head Slotted

Machine Screw, Flat Head Slotted,
1/4-20 Thread

b = 0.15
c = 0.48

Part No.	Length (a)
PK1420-14FHS-01	1/4"
PK1420-38FHS-01	3/8"
PK1420-12FHS-01	1/2"
PK1420-58FHS-01	5/8"
PK1420-34FHS-01	3/4"
PK1420-78FHS-01	7/8"
PK1420-11FHS-01	1"
PK1420-118FHS-01	1 1/8"
PK1420-114FHS-01	1 1/4"
PK1420-138FHS-01	1 3/8"
PK1420-112FHS-01	1 1/2"
PK1420-158FHS-01	1 5/8"
PK1420-134FHS-01	1 3/4"
PK1420-178FHS-01	1 7/8"
PK1420-21FHS-01	2"
PK1420-218FHS-01	2 1/8"
PK1420-214FHS-01	2 1/4"
PK1420-238FHS-01	2 3/8"
PK1420-212FHS-01	2 1/2"

5/16-18 Flat Head Slotted

Machine Screw, Flat Head Slotted,
5/16-18 Thread

b = 0.19
c = 0.60

Part No.	Length (a)
PK51618-14FHS-01	1/4"
PK51618-38FHS-01	3/8"
PK51618-12FHS-01	1/2"
PK51618-58FHS-01	5/8"
PK51618-34FHS-01	3/4"
PK51618-78FHS-01	7/8"
PK51618-11FHS-01	1"
PK51618-118FHS-01	1 1/8"
PK51618-114FHS-01	1 1/4"
PK51618-138FHS-01	1 3/8"
PK51618-112FHS-01	1 1/2"
PK51618-158FHS-01	1 5/8"
PK51618-134FHS-01	1 3/4"
PK51618-178FHS-01	1 7/8"
PK51618-21FHS-01	2"
PK51618-218FHS-01	2 1/8"
PK51618-214FHS-01	2 1/4"
PK51618-238FHS-01	2 3/8"
PK51618-212FHS-01	2 1/2"

1/4-28 Flat Head Slotted

Machine Screw, Flat Head Slotted,
1/4-28 Thread

b = 0.15
c = 0.48

Part No.	Length (a)
PK1428-14FHS-01	1/4"
PK1428-38FHS-01	3/8"
PK1428-12FHS-01	1/2"
PK1428-58FHS-01	5/8"
PK1428-34FHS-01	3/4"
PK1428-78FHS-01	7/8"
PK1428-11FHS-01	1"
PK1428-118FHS-01	1 1/8"
PK1428-114FHS-01	1 1/4"
PK1428-138FHS-01	1 3/8"
PK1428-112FHS-01	1 1/2"
PK1428-158FHS-01	1 5/8"
PK1428-134FHS-01	1 3/4"
PK1428-178FHS-01	1 7/8"
PK1428-21FHS-01	2"
PK1428-218FHS-01	2 1/8"
PK1428-214FHS-01	2 1/4"
PK1428-238FHS-01	2 3/8"
PK1428-212FHS-01	2 1/2"

3/8-16 Flat Head Slotted

Machine Screw, Flat Head Slotted,
3/8 16 Thread

b = 0.23
c = 0.70

Part No.	Length (a)
PK3816-14FHS-01	1/4"
PK3816-38FHS-01	3/8"
PK3816-12FHS-01	1/2"
PK3816-58FHS-01	5/8"
PK3816-34FHS-01	3/4"
PK3816-78FHS-01	7/8"
PK3816-11FHS-01	1"
PK3816-118FHS-01	1 1/8"
PK3816-114FHS-01	1 1/4"
PK3816-138FHS-01	1 3/8"
PK3816-112FHS-01	1 1/2"
PK3816-158FHS-01	1 5/8"
PK3816-134FHS-01	1 3/4"
PK3816-178FHS-01	1 7/8"
PK3816-21FHS-01	2"
PK3816-218FHS-01	2 1/8"
PK3816-214FHS-01	2 1/4"
PK3816-238FHS-01	2 3/8"
PK3816-212FHS-01	2 1/2"

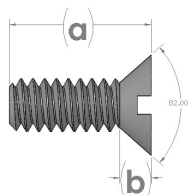
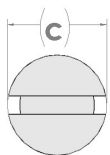

Part Numbers listed on this page are made from **30% Glass Filled PEEK**.

Available material grades are:

30% Carbon Filled – **Ca** (ex. PK440-78PHP-**Ca**)

Unfilled PEEK – **UF01** (ex. PK440-78PHP-**UF01**)

High Temperature PEEK, 30% Glass Filled– **HT01** (ex. PK440-78PHP-**HT01**)

High Temperature PEEK, 30% Carbon Filled – **HTCa** (ex. PK440-78PHP-**HTCa**)

Part Number ending in **-01** is for natural PEEK.

Standard colors are: **-02** Black, **-03** Blue, **-04** Red, **-05** Green, **-06** Yellow.

Other sizes, types, colors, and color matches available as special orders.
Please call for details.



3/8-24 Flat Head Slotted

Machine Screw, Flat Head Slotted,
3/8-24 Thread

b = 0.23
c = 0.70

Part No.	Length (a)
PK3824-14FHS-01	1/4"
PK3824-38FHS-01	3/8"
PK3824-12FHS-01	1/2"
PK3824-58FHS-01	5/8"
PK3824-34FHS-01	3/4"
PK3824-78FHS-01	7/8"
PK3824-11FHS-01	1"
PK3824-118FHS-01	1 1/8"
PK3824-114FHS-01	1 1/4"
PK3824-138FHS-01	1 3/8"
PK3824-112FHS-01	1 1/2"
PK3824-158FHS-01	1 5/8"
PK3824-134FHS-01	1 3/4"
PK3824-178FHS-01	1 7/8"
PK3824-21FHS-01	2"
PK3824-218FHS-01	2 1/8"
PK3824-214FHS-01	2 1/4"
PK3824-238FHS-01	2 3/8"
PK3824-212FHS-01	2 1/2"

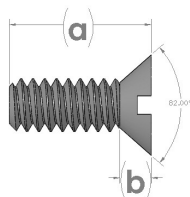
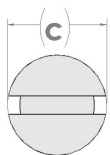

Part Numbers listed on this page are made from **30% Glass Filled PEEK**.
 Available material grades are:
 30% Carbon Filled – **Ca** (ex. PK440-78PHP-**Ca**)
 Unfilled PEEK – **UF01** (ex. PK440-78PHP-**UF01**)
 High Temperature PEEK, 30% Glass Filled– **HT01** (ex. PK440-78PHP-**HT01**)
 High Temperature PEEK, 30% Carbon Filled – **HTCa** (ex. PK440-78PHP-**HTCa**)

Part Number ending in **-01** is for natural PEEK.
 Standard colors are: **-02** Black, **-03** Blue, **-04** Red, **-05** Green, **-06** Yellow.
 Other sizes, types, colors, and color matches available as special orders.
 Please call for details.

0-80 Hex Head

Machine Screw, Hex Head,
0-80 Thread

b = 0.03
c = 0.12
d = 0.13

Part No.	Length (a)
PK080-14HH-01	1/4"
PK080-38HH-01	3/8"
PK080-12HH-01	1/2"

2-56 Hex Head

Machine Screw, Hex Head,
2-56 Thread

b = 0.04
c = 0.12
d = 0.13

Part No.	Length (a)
PK256-14HH-01	1/4"
PK256-38HH-01	3/8"
PK256-12HH-01	1/2"

4-40 Hex Head

Machine Screw, Hex Head,
4-40 Thread

b = 0.05
c = 0.18
d = 0.20

Part No.	Length (a)
PK440-14HH-01	1/4"
PK440-38HH-01	3/8"
PK440-12HH-01	1/2"
PK440-58HH-01	5/8"
PK440-34HH-01	3/4"
PK440-78HH-01	7/8"
PK440-11HH-01	1"

6-32 Hex Head

Machine Screw, Hex Head,
6-32 Thread

b = 0.09
c = 0.25
d = 0.27

Part No.	Length (a)
PK632-14HH-01	1/4"
PK632-38HH-01	3/8"
PK632-12HH-01	1/2"
PK632-58HH-01	5/8"
PK632-34HH-01	3/4"
PK632-78HH-01	7/8"
PK632-11HH-01	1"
PK632-118HH-01	1 1/8"
PK632-114HH-01	1 1/4"

8-32 Hex Head

Machine Screw, Hex Head,
8-32 Thread

b = 0.10
c = 0.25
d = 0.27

Part No.	Length (a)
PK832-14HH-01	1/4"
PK832-38HH-01	3/8"
PK832-12HH-01	1/2"
PK832-58HH-01	5/8"
PK832-34HH-01	3/4"
PK832-78HH-01	7/8"
PK832-11HH-01	1"
PK832-118HH-01	1 1/8"
PK832-114HH-01	1 1/4"
PK832-138HH-01	1 3/8"
PK832-112HH-01	1 1/2"

10-24 Hex Head

Machine Screw, Hex Head,
8-32 Thread

b = 0.11
c = 0.31
c = 0.34

Part No.	Length (a)
PK1024-14HH-01	1/4"
PK1024-38HH-01	3/8"
PK1024-12HH-01	1/2"
PK1024-58HH-01	5/8"
PK1024-34HH-01	3/4"
PK1024-78HH-01	7/8"
PK1024-11HH-01	1"
PK1024-118HH-01	1 1/8"
PK1024-114HH-01	1 1/4"
PK1024-138HH-01	1 3/8"
PK1024-112HH-01	1 1/2"
PK1024-158HH-01	1 5/8"
PK1024-134HH-01	1 3/4"
PK1024-178HH-01	1 7/8"
PK1024-21HH-01	2"

10-32 Hex Head

Machine Screw, Hex Head,
10-32 Thread

b = 0.11
c = 0.31
d = 0.34

Part No.	Length (a)
PK1032-14HH-01	1/4"
PK1032-38HH-01	3/8"
PK1032-12HH-01	1/2"
PK1032-58HH-01	5/8"
PK1032-34HH-01	3/4"
PK1032-78HH-01	7/8"
PK1032-11HH-01	1"
PK1032-118HH-01	1 1/8"
PK1032-114HH-01	1 1/4"
PK1032-138HH-01	1 3/8"
PK1032-112HH-01	1 1/2"
PK1032-158HH-01	1 5/8"
PK1032-134HH-01	1 3/4"
PK1032-178HH-01	1 7/8"
PK1032-21HH-01	2"

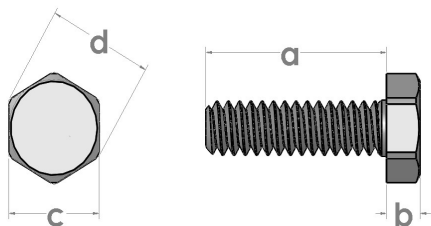

Part Numbers listed on this page are made from **30% Glass Filled PEEK**. Available material grades are:
 30% Carbon Filled – **-Ca** (ex. PK440-78PHP-**Ca**)
 Unfilled PEEK – **-UF01** (ex. PK440-78PHP-**UF01**)
 High Temperature PEEK, 30% Glass Filled– **-HT01** (ex. PK440-78PHP-**HT01**)
 High Temperature PEEK, 30% Carbon Filled – **-HTCa** (ex. PK440-78PHP-**HTCa**)

Part Number ending in **-01** is for natural PEEK.
 Standard colors are: **-02** Black, **-03** Blue, **-04** Red, **-05** Green, **-06** Yellow.
 Other sizes, types, colors, and color matches available as special orders. Please call for details.

1/4-20 Hex Head	Part No.	Length (a)
Machine Screw, Hex Head, 1/4-20 Thread b = 0.18 c = 0.37 d = 0.40	PK1420-14HH-01	1/4"
	PK1420-38HH-01	3/8"
	PK1420-12HH-01	1/2"
	PK1420-58HH-01	5/8"
	PK1420-34HH-01	3/4"
	PK1420-78HH-01	7/8"
	PK1420-11HH-01	1"
	PK1420-118HH-01	1 1/8"
	PK1420-114HH-01	1 1/4"
	PK1420-138HH-01	1 3/8"
	PK1420-112HH-01	1 1/2"
	PK1420-158HH-01	1 5/8"
	PK1420-134HH-01	1 3/4"
	PK1420-178HH-01	1 7/8"
	PK1420-21HH-01	2"
	PK1420-218HH-01	2 1/8"
	PK1420-214HH-01	2 1/4"
	PK1420-238HH-01	2 3/8"
	PK1420-212HH-01	2 1/2"

5/16-18 Hex Head	Part No.	Length (a)
Machine Screw, Hex Head, 5/16-18 Thread b = 0.18 c = 0.49 d = 0.55	PK51618-14HH-01	1/4"
	PK51618-38HH-01	3/8"
	PK51618-12HH-01	1/2"
	PK51618-58HH-01	5/8"
	PK51618-34HH-01	3/4"
	PK51618-78HH-01	7/8"
	PK51618-11HH-01	1"
	PK51618-118HH-01	1 1/8"
	PK51618-114HH-01	1 1/4"
	PK51618-138HH-01	1 3/8"
	PK51618-112HH-01	1 1/2"
	PK51618-158HH-01	1 5/8"
	PK51618-134HH-01	1 3/4"
	PK51618-178HH-01	1 7/8"
	PK51618-21HH-01	2"
	PK51618-218HH-01	2 1/8"
	PK51618-214HH-01	2 1/4"
	PK51618-238HH-01	2 3/8"
	PK51618-212HH-01	2 1/2"

1/4-28 Hex Head	Part No.	Length (a)
Machine Screw, Hex head, 1/4-28 Thread b = 0.18 c = 0.37 d = 0.40	PK1428-14HH-01	1/4"
	PK1428-38HH-01	3/8"
	PK1428-12HH-01	1/2"
	PK1428-58HH-01	5/8"
	PK1428-34HH-01	3/4"
	PK1428-78HH-01	7/8"
	PK1428-11HH-01	1"
	PK1428-118HH-01	1 1/8"
	PK1428-114HH-01	1 1/4"
	PK1428-138HH-01	1 3/8"
	PK1428-112HH-01	1 1/2"
	PK1428-158HH-01	1 5/8"
	PK1428-134HH-01	1 3/4"
	PK1428-178HH-01	1 7/8"
	PK1428-21HH-01	2"
	PK1428-218HH-01	2 1/8"
	PK1428-214HH-01	2 1/4"
	PK1428-238HH-01	2 3/8"
	PK1428-212HH-01	2 1/2"

3/8-16 Hex Head	Part No.	Length (a)
Machine Screw, Hex Head, 3/8 16 Thread b = 0.28 c = 0.56 d = 0.61	PK3816-14HH-01	1/4"
	PK3816-38HH-01	3/8"
	PK3816-12HH-01	1/2"
	PK3816-58HH-01	5/8"
	PK3816-34HH-01	3/4"
	PK3816-78HH-01	7/8"
	PK3816-11HH-01	1"
	PK3816-118HH-01	1 1/8"
	PK3816-114HH-01	1 1/4"
	PK3816-138HH-01	1 3/8"
	PK3816-112HH-01	1 1/2"
	PK3816-158HH-01	1 5/8"
	PK3816-134HH-01	1 3/4"
	PK3816-178HH-01	1 7/8"
	PK3816-21HH-01	2"
	PK3816-218HH-01	2 1/8"
	PK3816-214HH-01	2 1/4"
	PK3816-238HH-01	2 3/8"
	PK3816-212HH-01	2 1/2"

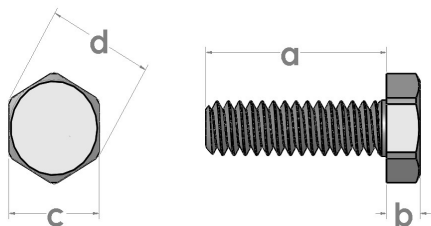

Part Numbers listed on this page are made from **30% Glass Filled PEEK**. Available material grades are:
 30% Carbon Filled – **Ca** (ex. PK440-78PHP-**Ca**)
 Unfilled PEEK – **UF01** (ex. PK440-78PHP-**UF01**)
 High Temperature PEEK, 30% Glass Filled– **HT01** (ex. PK440-78PHP-**HT01**)
 High Temperature PEEK, 30% Carbon Filled – **HTCa** (ex. PK440-78PHP-**HTCa**)

Part Number ending in **-01** is for natural PEEK.
 Standard colors are: **-02** Black, **-03** Blue, **-04** Red, **-05** Green, **-06** Yellow.
 Other sizes, types, colors, and color matches available as special orders. Please call for details.

3/8-24 Hex Head

Machine Screw, Hex Head,
3/8-24 Thread

b = 0.28
c = 0.56
d = 0.61

Part No.	Length (a)
PK3824-14HH-01	1/4"
PK3824-38HH-01	3/8"
PK3824-12HH-01	1/2"
PK3824-58HH-01	5/8"
PK3824-34HH-01	3/4"
PK3824-78HH-01	7/8"
PK3824-11HH-01	1"
PK3824-118HH-01	1 1/8"
PK3824-114HH-01	1 1/4"
PK3824-138HH-01	1 3/8"
PK3824-112HH-01	1 1/2"
PK3824-158HH-01	1 5/8"
PK3824-134HH-01	1 3/4"
PK3824-178HH-01	1 7/8"
PK3824-21HH-01	2"
PK3824-218HH-01	2 1/8"
PK3824-214HH-01	2 1/4"
PK3824-238HH-01	2 3/8"
PK3824-212HH-01	2 1/2"

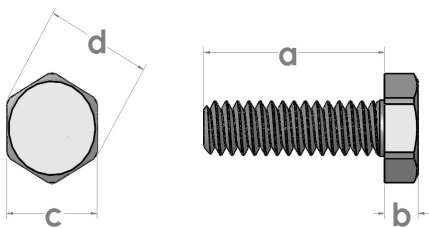

Part Numbers listed on this page are made from **30% Glass Filled PEEK**.
Available material grades are:

30% Carbon Filled – **Ca** (ex. PK440-78PHP-**Ca**)

Unfilled PEEK – **UF01** (ex. PK440-78PHP-**UF01**)

High Temperature PEEK, 30% Glass Filled – **HT01** (ex. PK440-78PHP-**HT01**)

High Temperature PEEK, 30% Carbon Filled – **HTCa** (ex. PK440-78PHP-**HTCa**)

Part Number ending in **-01** is for natural PEEK.

Standard colors are: **-02** Black, **-03** Blue, **-04** Red, **-05** Green, **-06** Yellow.

Other sizes, types, colors, and color matches available as special orders.
Please call for details.

PEEK Socket Head Cap Screws

4-40 Socket Head	Part No.	Length (a)
Machine Screw, Socket Head Cap, 4-40 Thread	PK440-14CHP-01	1/4"
	PK440-38CHP-01	3/8"
	PK440-12CHP-01	1/2"
	PK440-58CHP-01	5/8"
	PK440-34CHP-01	3/4"
	PK440-78CHP-01	7/8"
	PK440-34CHP-01	1"

b = 0.11
c = 0.18
d = 0.09
e = 0.08

6-32 Socket Head	Part No.	Length (a)
Machine Screw, Socket Head, 6-32 Thread	PK632-14CHS-01	1/4"
	PK632-38CHS-01	3/8"
	PK632-12CHS-01	1/2"
	PK632-58CHS-01	5/8"
	PK632-34CHS-01	3/4"
	PK632-78CHS-01	7/8"
	PK632-11CHS-01	1"
	PK632-118CHS-01	1 1/8"
	PK632-114CHS-01	1 1/4"

b = 0.14
c = 0.23
d = 0.11
e = 0.10

8-32 Socket Head	Part No.	Length (a)
Machine Screw, Socket Head, 8-32 Thread	PK832-14HH-01	1/4"
	PK832-38HH-01	3/8"
	PK832-12HH-01	1/2"
	PK832-58HH-01	5/8"
	PK832-34HH-01	3/4"
	PK832-78HH-01	7/8"
	PK832-11HH-01	1"
	PK832-118HH-01	1 1/8"
	PK832-114HH-01	1 1/4"
	PK832-138HH-01	1 3/8"
PK832-112HH-01	1 1/2"	

b = 0.16
c = 0.27
d = 0.14
e = 0.12

10-24 Hex Head	Part No.	Length (a)
Machine Screw, Socket Head, 10-24 Thread	PK1024-14HH-01	1/4"
	PK1024-38HH-01	3/8"
	PK1024-12HH-01	1/2"
	PK1024-58HH-01	5/8"
	PK1024-34HH-01	3/4"
	PK1024-78HH-01	7/8"
	PK1024-11HH-01	1"
	PK1024-118HH-01	1 1/8"
	PK1024-114HH-01	1 1/4"
	PK1024-138HH-01	1 3/8"
	PK1024-112HH-01	1 1/2"
	PK1024-158HH-01	1 5/8"
	PK1024-134HH-01	1 3/4"
	PK1024-178HH-01	1 7/8"
	PK1024-21HH-01	2"

b = 0.19
c = 0.31
d = 0.16
e = 0.14

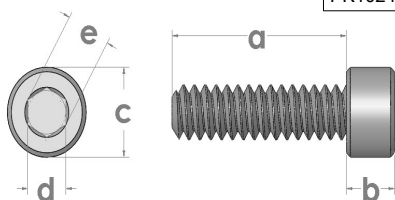

10-32 Socket Head	Part No.	Length (a)
Machine Screw, Socket Head, 10-32 Thread	PK1032-14HH-01	1/4"
	PK1032-38HH-01	3/8"
	PK1032-12HH-01	1/2"
	PK1032-58HH-01	5/8"
	PK1032-34HH-01	3/4"
	PK1032-78HH-01	7/8"
	PK1032-11HH-01	1"
	PK1032-118HH-01	1 1/8"
	PK1032-114HH-01	1 1/4"
	PK1032-138HH-01	1 3/8"
	PK1032-112HH-01	1 1/2"
	PK1032-158HH-01	1 5/8"
	PK1032-134HH-01	1 3/4"
	PK1032-178HH-01	1 7/8"
PK1032-21HH-01	2"	

b = 0.19
c = 0.31
d = 0.16
e = 0.14

1/4-20 Socket Head	Part No.	Length (a)
Machine Screw, Socket Head, 1/4-20 Thread	PK1420-14PHS-01	1/4"
	PK1420-38PHS-01	3/8"
	PK1420-12PHS-01	1/2"
	PK1420-58PHS-01	5/8"
	PK1420-34PHS-01	3/4"
	PK1420-78PHS-01	7/8"
	PK1420-11PHS-01	1"
	PK1420-118PHS-01	1 1/8"
	PK1420-114PHS-01	1 1/4"
	PK1420-138PHS-01	1 3/8"
	PK1420-112PHS-01	1 1/2"
	PK1420-158PHS-01	1 5/8"
	PK1420-134PHS-01	1 3/4"
	PK1420-178PHS-01	1 7/8"
	PK1420-21PHS-01	2"
	PK1420-218PHS-01	2 1/8"
	PK1420-214PHS-01	2 1/4"
	PK1420-238PHS-01	2 3/8"
PK1420-212PHS-01	2 1/2"	

b = 0.25
c = 0.37
d = 0.19
e = 0.16

Part Numbers listed on this page are made from **30% Glass Filled PEEK**. Available material grades are:
 30% Carbon Filled – **Ca** (ex. PK440-78PHP-**Ca**)
 Unfilled PEEK – **UF01** (ex. PK440-78PHP-**UF01**)
 High Temperature PEEK, 30% Glass Filled – **HT01** (ex. PK440-78PHP-**HT01**)
 High Temperature PEEK, 30% Carbon Filled – **HTCa** (ex. PK440-78PHP-**HTCa**)

Part Number ending in **-01** is for natural PEEK.
 Standard colors are: **-02** Black, **-03** Blue, **-04** Red, **-05** Green, **-06** Yellow.
 Other sizes, types, colors, and color matches available as special orders. Please call for details.

1/4-28 Socket Head	Part No.	Length (a)
Machine Screw, Socket Head, 1/4-20 Thread	PK1420-14PHS-01	1/4"
	PK1420-38PHS-01	3/8"
	PK1420-12PHS-01	1/2"
	PK1420-58PHS-01	5/8"
	PK1420-34PHS-01	3/4"
	PK1420-78PHS-01	7/8"
	PK1420-11PHS-01	1"
	PK1420-118PHS-01	1 1/8"
	PK1420-114PHS-01	1 1/4"
	PK1420-138PHS-01	1 3/8"
	PK1420-112PHS-01	1 1/2"
	PK1420-158PHS-01	1 5/8"
	PK1420-134PHS-01	1 3/4"
	PK1420-178PHS-01	1 7/8"
	PK1420-21PHS-01	2"
	PK1420-218PHS-01	2 1/8"
	PK1420-214PHS-01	2 1/4"
	PK1420-238PHS-01	2 3/8"
	PK1420-212PHS-01	2 1/2"

b = 0.25
c = 0.37
d = 0.19
e = 0.16

5/16-18 Socket Head	Part No.	Length (a)
Machine Screw, Socket Head, 5/16-18 Thread	PK51618-14PHS-01	1/4"
	PK51618-38PHS-01	3/8"
	PK51618-12PHS-01	1/2"
	PK51618-58PHS-01	5/8"
	PK51618-34PHS-01	3/4"
	PK51618-78PHS-01	7/8"
	PK51618-11PHS-01	1"
	PK51618-118PHS-01	1 1/8"
	PK51618-114PHS-01	1 1/4"
	PK51618-138PHS-01	1 3/8"
	PK51618-112PHS-01	1 1/2"
	PK51618-158PHS-01	1 5/8"
	PK51618-134PHS-01	1 3/4"
	PK51618-178PHS-01	1 7/8"
	PK51618-21PHS-01	2"
	PK51618-218PHS-01	2 1/8"
	PK51618-214PHS-01	2 1/4"
	PK51618-238PHS-01	2 3/8"
	PK51618-212PHS-01	2 1/2"

b = 0.31
c = 0.46
d = 0.25
e = 0.20

3/8-16 Socket Head	Part No.	Length (a)
Machine Screw, Socket Head, 3/8 16 Thread	PK3816-14PHS-01	1/4"
	PK3816-38PHS-01	3/8"
	PK3816-12PHS-01	1/2"
	PK3816-58PHS-01	5/8"
	PK3816-34PHS-01	3/4"
	PK3816-78PHS-01	7/8"
	PK3816-11PHS-01	1"
	PK3816-118PHS-01	1 1/8"
	PK3816-114PHS-01	1 1/4"
	PK3816-138PHS-01	1 3/8"
	PK3816-112PHS-01	1 1/2"
	PK3816-158PHS-01	1 5/8"
	PK3816-134PHS-01	1 3/4"
	PK3816-178PHS-01	1 7/8"
	PK3816-21PHS-01	2"
	PK3816-218PHS-01	2 1/8"
	PK3816-214PHS-01	2 1/4"
	PK3816-238PHS-01	2 3/8"
	PK3816-212PHS-01	2 1/2"

b = 0.37
c = 0.56
d = 0.31
e = 0.27

3/8-24 Socket Head	Part No.	Length (a)
Machine Screw, Socket Head, 3/8-24 Thread	PK3824-14PHS-01	1/4"
	PK3824-38PHS-01	3/8"
	PK3824-12PHS-01	1/2"
	PK3824-58PHS-01	5/8"
	PK3824-34PHS-01	3/4"
	PK3824-78PHS-01	7/8"
	PK3824-11PHS-01	1"
	PK3824-118PHS-01	1 1/8"
	PK3824-114PHS-01	1 1/4"
	PK3824-138PHS-01	1 3/8"
	PK3824-112PHS-01	1 1/2"
	PK3824-158PHS-01	1 5/8"
	PK3824-134PHS-01	1 3/4"
	PK3824-178PHS-01	1 7/8"
	PK3824-21PHS-01	2"
	PK3824-218PHS-01	2 1/8"
	PK3824-214PHS-01	2 1/4"
	PK3824-238PHS-01	2 3/8"
	PK3824-212PHS-01	2 1/2"

b = 0.37
c = 0.56
d = 0.31
e = 0.27

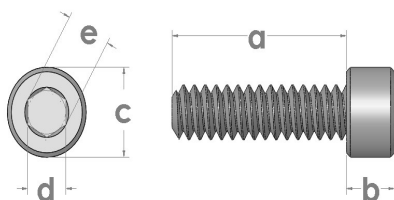

Part Numbers listed on this page are made from **30% Glass Filled PEEK**. Available material grades are:
 30% Carbon Filled – **Ca** (ex. PK440-78PHP-**Ca**)
 Unfilled PEEK – **UF01** (ex. PK440-78PHP-**UF01**)
 High Temperature PEEK, 30% Glass Filled– **HT01** (ex. PK440-78PHP-**HT01**)
 High Temperature PEEK, 30% Carbon Filled – **HTCa** (ex. PK440-78PHP-**HTCa**)

Part Number ending in **-01** is for natural PEEK.
 Standard colors are: **-02** Black, **-03** Blue, **-04** Red, **-05** Green, **-06** Yellow.
 Other sizes, types, colors, and color matches available as special orders. Please call for details.

6-32 Nuts

Machine Nuts,
6-32 Thread

a = 6-32
b = 0.32
c = 0.12
d = 0.36

Number	Color
PK632-NTS-01	Natural
PK632-NTS-02	Black
PK632-NTS-03	Blue
PK632-NTS-04	Red
PK632-NTS-05	Green
PK632-NTS-06	Yellow

3/8-16 Nuts

Machine Nuts,
3/8-16 Thread,

a = 3/8-16
b = 0.62
c = 0.25
d = 0.72

Number	Color
PK3816-NTS-01	Natural
PK3816-NTS-02	Black
PK3816-NTS-03	Blue
PK3816-NTS-04	Red
PK3816-NTS-05	Green
PK3816-NTS-06	Yellow

8-32 Nuts

Machine Nuts,
8-32 Thread

a = 8-32
b = 0.35
c = 0.13
d = 0.40

Number	Color
PK832-NTS-01	Natural
PK832-NTS-02	Black
PK832-NTS-03	Blue
PK832-NTS-04	Red
PK832-NTS-05	Green
PK832-NTS-06	Yellow

Ca Series, Carbon Filled

PEEK Machine Nuts,
Carbon filled.*

Number	Color
PK632-NTS-Ca	Black
PK832-NTS-Ca	Black
PK1032-NTS-Ca	Black
PK1420-NTS-Ca	Black
PK51618-NTS-Ca	Black
PK3816-NTS-Ca	Black

10-32 Nuts

Machine Nuts,
10-32 Thread,

a = 10-32
b = 0.38
c = 0.13
d = 0.43

Number	Color
PK1032-NTS-01	Natural
PK1032-NTS-02	Black
PK1032-NTS-03	Blue
PK1032-NTS-04	Red
PK1032-NTS-05	Green
PK1032-NTS-06	Yellow

1/4-20 Nuts

Machine Nuts,
1/4-20 Thread

a = 1/4-20
b = 0.44
c = 0.18
d = 0.48

Number	Color
PK1420-NTS-01	Natural
PK1420-NTS-02	Black
PK1420-NTS-03	Blue
PK1420-NTS-04	Red
PK1420-NTS-05	Green
PK1420-NTS-06	Yellow

5/16-18 Nuts

Machine Nuts,
5/16-18 Thread

a = 5/16-18
b = 0.56
c = 0.22
d = 0.64

Number	Color
PK51618-NTS-01	Natural
PK51618-NTS-02	Black
PK51618-NTS-03	Blue
PK51618-NTS-04	Red
PK51618-NTS-05	Green
PK51618-NTS-06	Yellow

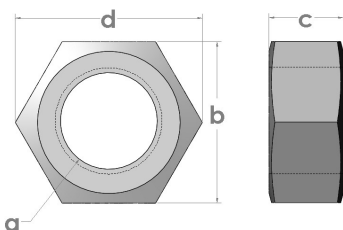

Part Numbers listed on this page are made from **30% Glass Filled PEEK**.

Available material grades are:

30% Carbon Filled – **Ca** (ex. PK440-78PHP-**Ca**)

Unfilled PEEK – **UF01** (ex. PK440-78PHP-**UF01**)

High Temperature PEEK, 30% Glass Filled – **HT01** (ex. PK440-78PHP-**HT01**)

High Temperature PEEK, 30% Carbon Filled – **HTCa** (ex. PK440-78PHP-**HTCa**)

Part Number ending in **-01** is for natural PEEK.

Standard colors are: **-02** Black, **-03** Blue, **-04** Red, **-05** Green, **-06** Yellow.

Other sizes, types, colors, and color matches available as special orders.
Please call for details.

#6 Washer	Number	Color
Machine Washers, #6	PK6-WHS-01	Natural
	PK6-WHS-02	Black
	PK6-WHS-03	Blue
	PK6-WHS-04	Red
	PK6-WHS-05	Green
	PK6-WHS-06	Yellow

a = 0.375
b = 0.082
c = 0.268

#8 Washer	Number	Color
Machine Washers, #8	PK8-WHS-01	Natural
	PK8-WHS-02	Black
	PK8-WHS-03	Blue
	PK8-WHS-04	Red
	PK8-WHS-05	Green
	PK8-WHS-06	Yellow

a = 0.500
b = 0.082
c = 0.268

#10 Washer	Number	Color
Machine Washers, #10	PK10-WHS-01	Natural
	PK10-WHS-02	Black
	PK10-WHS-03	Blue
	PK10-WHS-04	Red
	PK10-WHS-05	Green
	PK10-WHS-06	Yellow

a = 0.750
b = 0.082
c = 0.268

1/4 Washer	Number	Color
Machine Washers, 1/4"	PK14-WHS-01	Natural
	PK14-WHS-02	Black
	PK14-WHS-03	Blue
	PK14-WHS-04	Red
	PK14-WHS-05	Green
	PK14-WHS-06	Yellow

a = 0.375
b = 0.096
c = 0.314

5/16 Washer	Number	Color
Machine Washers, 5/16"	PK516-WHS-01	Natural
	PK516-WHS-02	Black
	PK516-WHS-03	Blue
	PK516-WHS-04	Red
	PK516-WHS-05	Green
	PK516-WHS-06	Yellow

a = 0.500
b = 0.096
c = 0.314

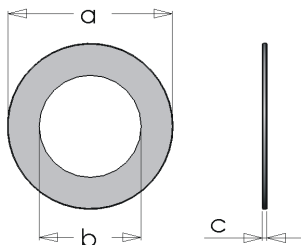

3/8 Washer	Number	Color
Machine Washers, 3/8"	PK38-WHS-01	Natural
	PK38-WHS-02	Black
	PK38-WHS-03	Blue
	PK38-WHS-04	Red
	PK38-WHS-05	Green
	PK38-WHS-06	Yellow

a = 0.500
b = 0.096
c = 0.314

Ca Series, Carbon Filled	Number	Color
PEEK Machine Washers, Carbon filled.*	PK6-WHS-Ca	Black
	PK8-WHS-Ca	Black
	PK10-WHS-Ca	Black
	PK14-WHS-Ca	Black
	PK516-WHS-Ca	Black
	PK38-WHS-Ca	Black

* Carbon filled screws are available in all sizes listed on this page. Carbon filling is used instead of glass and has added benefits such as static conductivity, increased strength and rigidity. Carbon filled screws come only in black.

Part Numbers listed on this page are made from **30% Glass Filled PEEK**. Available material grades are:
 30% Carbon Filled – **Ca** (ex. PK440-78PHP-**Ca**)
 Unfilled PEEK – **UF01** (ex. PK440-78PHP-**UF01**)
 High Temperature PEEK, 30% Glass Filled – **HT01** (ex. PK440-78PHP-**HT01**)
 High Temperature PEEK, 30% Carbon Filled – **HTCa** (ex. PK440-78PHP-**HTCa**)

Part Number ending in **-01** is for natural PEEK.
 Standard colors are: **-02** Black, **-03** Blue, **-04** Red, **-05** Green, **-06** Yellow.

Other sizes, types, colors, and color matches available as special orders. Please call for details.

43 Faxable Order Form

Shipping:

Company: _____
 Attn: _____
 Address: _____
 City: _____ State/Province: _____
 Post Office Code: _____ Country: _____
 Phone: _____ Fax: _____
 Email: _____
 PO #: _____

Billing: (If different from shipping.)

Company: _____
 Attn: _____
 Address: _____
 City: _____ State/Province: _____
 Post Office Code: _____ Country: _____
 Phone: _____ Fax: _____
 Email: _____

TEI does not accept returns, except on defective product. All returns require an RA (Return Authorization) issued from TEI.

Part #	Date Required	Description	Quantity	Unit
Cost	Total			
2				
3				
4				
5				
6				
7				
8				
9				
10				
11				
12				
13				
14				
15				
16				

Fax this form at 847.816.0130 of mail to:
 Technique Eng., Inc.
 43950 Polo Trail Dr.
 Lake Forest, IL 60045-5013
 Attn: Orders

Subtotal: _____
 State Tax: _____
 resale certificate must be on file
 Shipping: _____
 call for details

GRAND TOTAL: _____

	Carrier	Service	Account Number
Shipping	UPS	Ground	_____
	FEDEX	2nd Day	
	DHL	Next Day	
Options:	Other: _____	Worldwide	Optional